

An
Bord
Pleanála

Application Form for Permission / Approval in respect of a Strategic Infrastructure Development

1.

Please specify the statutory provision under which your application is being made:	Section 37E of the Planning and Development Act 2000, as amended.
--	--

2. **Applicant:**

Name of Applicant:	Bord na Móna Powergen Limited
Address:	Bord na Móna Main Street Newbridge Co. Kildare
Telephone No:	045 439 000
Email Address (if any):	N/A

3. **Where Applicant is a company (registered under the Companies Acts):**

Name(s) of company director(s):	Thomas Egan, Joseph Coleman, John Patrick Reilly
Registered Address (of company)	Bord na Móna, Main Street, Newbridge, Co. Kildare.
Company Registration No.	218162

Telephone No.	045 439 000
Email Address (if any)	N/A

4. Person / Agent acting on behalf of the Applicant (if any):

Name:	Sean Breslin
Address:	Gravis Planning 41 Baggot Street Lower Dublin 2 D02 NN67
Telephone No.	01 224 1590
Mobile No. (if any)	N/A
Email address (if any)	sbreslin@gravisplanning.com

Should all correspondence be sent to the above address? (Please tick appropriate box)

(Please note that if the answer is "No", all correspondence will be sent to the Applicant's address)

Yes: [] No: []

Contact Name and Contact Details (Phone number) for arranging entry on site if required / appropriate:

Contact: Sean Breslin, Gravis Planning

Phone: 01 224 1590

Email: sbreslin@gravisplanning.com

5. Person responsible for preparation of Drawings and Plans:

Name:	David Winterbottom
Firm / Company:	Fichtner Consulting Engineers Limited
Address:	77 Sir John Rogerson's Quay Block C Grand Canal Docklands Dublin 2

	D02 VK60
Telephone No:	01 506 0632
Mobile No:	N/A
Email Address (if any):	DavidWinterbottom@fichtner.co.uk
<p>Details all plans / drawings submitted – title of drawings / plans, scale and no. of copies submitted. This can be submitted as a separate schedule with the application form.</p> <p>Please refer to Appendix A</p>	

6. Site:

Site Address / Location of the Proposed Development (as may best identify the land or structure in question)	Land within the townlands of Knockdrin, Derrygreenagh, Derryarkin, Derryiron, Ballybeg, Coolcor, Barrysbrook, Clonin, Togher and Coole, Co. Offaly.
Ordnance Survey Map Ref No. (and the Grid Reference where available)	Map Sheets: 3114, 3115, 3116, 3180, 3181, 3182, 3246, 3247, 3248, 3311, 3312, 3313
<p>Where available, please provide the application site boundary, as shown in the submitted plans / drawings, as an ESRI shapefile in the Irish Transverse Mercator (ITM IRENET95) co-ordinate reference system. Alternatively, a CAD file in .dwg format, with all geometry referenced to ITM, may be provided.</p>	
Area of site to which the application relates in hectares	c. 312 ha
Site zoning in current Development Plan for the area:	N/A – The land which is the subject of this application is not zoned under the current Development Plan
Existing use of the site & proposed use of the site:	<p>Existing Use</p> <p>Power Plant Area: Workshop/Stores (Existing Derrygreenagh Works)</p> <p>Electricity Grid Connection: Decommissioning and rehabilitation of former industrial peat extraction areas. Smaller area of Agricultural Grassland for proposed 400kV substation.</p>

	Proposed Use CCGT & OCGT Power Plant and Electricity Grid Connection.
Name of the Planning Authority(s) in whose functional area the site is situated:	Offaly County Council

7. Legal Interest of Applicant in respect of the site the subject of the application:

Please tick appropriate box to show applicant's legal interest in the land or structure:	Owner <input checked="" type="checkbox"/>	Occupier
	Other <input checked="" type="checkbox"/>	
Where legal interest is "Other", please expand further on your interest in the land or structure.		
The Applicant, or other Bord na Móna group companies, is the owner of all of the lands contained within the red line boundary, with the exception of lands on which the proposed new 400kV substation is to be located.		
If you are not the legal owner , please state the name and address of the owner and supply a letter from the owner of consent to make the application as listed in the accompanying documentation.		
Please refer to Appendix B for detail.		
Does the applicant own or have a beneficial interest in adjoining, abutting or adjacent lands? If so, identify the lands and state the interest.		
Yes.		
Please refer to the blue line boundary on Dwg. No. S7060-8050-0039 ('Overall Site Location Map') for full extent of land in Bord na Móna ownership.		

8. Site History:

Details regarding site history (if known):
Has the site in question ever, to your knowledge, been flooded? Yes: [<input type="checkbox"/>] No: [<input checked="" type="checkbox"/>] If yes, please give details e.g. year, extent: Are you aware of previous uses of the site e.g. dumping or quarrying? Yes: [<input checked="" type="checkbox"/>] No: [<input type="checkbox"/>]

If yes, please give details:

The Power Plant Area was previously used as a workshop and stores facility for servicing and repairing peat harvesting vehicles and equipment. The remainder of the Proposed Development was formerly used for commercial peat extraction, with the exception of the 400kV substation lands which were previously used for agricultural purposes.

Are you aware of any valid planning applications previously made in respect of this land / structure?

Yes: [] No: []

If yes, please state planning register reference number(s) of same if known and details of applications

Reg. Ref. No:	Nature of Proposed Development	Nature of Final Decision of Application Grant or Refusal by Planning Authority / An Bord Pleanála
19.PA0011	Construct a 600MW power plant development comprising of a 430MW Combined Cycle Gas Turbine unit and a 170MW Open Cycle Gas Turbine unit, and associated buildings and infrastructure.	Grant – An Bord Pleanála - 12/04/2010
PL2 07/1394	Pilot scale biodiesel processing facility.	Grant – Offaly County Council - 13/12/2007
PL2 04/988	Retain GSM base station.	Grant – Offaly County Council – 13/09/2004

If a valid planning application has been made in respect of this land or structure in the 6 months prior to the submission of this application, then any required site notice must be on a yellow background in accordance with Article 19(4) of the Planning and Development regulations 2001 as amended.

Is the site of the proposal subject to a current appeal to An Bord Pleanála in respect of a similar development?

Yes: [] No: []

If yes please specify

An Bord Pleanála Reference No.: _____

9. Description of the Proposed Development:

<p>Brief description of nature and extent of development</p>	<p>10-year planning permission to develop a Combined Cycle Gas Turbine ('CCGT') and Open Cycle Gas Turbine ('OCGT') Thermal Power Plant, Electricity Grid Connection including 2 no. substations, and associated buildings, plant, site works, services and ancillary development on land within the townlands of Knockdrin, Derrygreenagh, Derryarkin, Derryiron, Ballybeg, Coolcor, Barrysbrook, Clonin, Togher and Coole, Co. Offaly.</p> <p>The Proposed Development will encompass a Power Plant Area and an Electricity Grid Connection.</p> <p>The development of the Power Plant Area will include the following:</p> <ul style="list-style-type: none">• Demolition of existing buildings at the Derrygreenagh Works site (Including office building, boiler house, workshops, water tank and storage unit);• Construction of CCGT power plant (570MW) [Including turbine hall and associated buildings, air cooled condensers ('ACC'), Heat Recovery Steam Generator ('HRSG'), air intake, emissions stack (60m high) with Continuous Emissions Monitoring System ('CEMS') and platform];• Ancillary coolers;• Fuel gas performance heating room• Generator transformer and unit auxiliary transformer;• OCGT power plant (140MW) [Including turbine enclosures, air intakes, fin fan coolers, emissions stack (45m high), electrical rooms, main transformer];• Secondary fuel storage tanks and unloading area [Including unloading layby, 2 no. fuel storage tanks, fuel pumping and cleaning plant, fuel forwarding building];• 2 no. water abstraction boreholes;• Raw water storage tank;• 2 no. demineralised water storage tanks;• Water treatment plant;• Administration building and staff car park;• Wastewater treatment plant;• Workshop and stores building;• Process water treatment plant;
--	--

- Gas Above Ground Installation ('AGI') compound [Including regulator building, instrumentation kiosks, palisade fencing];
- Gas receiving facility [Including gas compressor building, fin fan coolers, pressure reducing station];
- Drainage infrastructure [Including surface water attenuation tank, surface water discharge pipeline (Discharging to the Mongagh River), treated process and wastewater discharge pipeline (Discharging to the Yellow River)];
- A new site access from the R400 road;
- All internal access roads;
- Security fencing and gates;
- Landscaping
- Site works and services
- All ancillary infrastructure and plant [Including firefighting systems, fire water pumphouse, raw water pumphouse, emergency diesel generator, propane stores, chemical storage tanks and pumphouse, lube oil storage building, silencers, vents, drains, safety valves, lighting, and pipe gantries];
- A permanent Peat and Spoil Deposition Area ('PDA') of approx. 225,000 sq. m. will be located to the south-east of the Power Plant Area.

The development of the Electricity Grid Connection will include the following:

- A 220kV substation located to the west of the Power Plant Area and R400 road [Hybrid gas insulated switchgear ('GIS')/air insulated switchgear ('AIS') substation design including switchgear building; control room building; transformer bays; 2. no. lattice gantries (c. 20m high) to support overhead line connection; telecommunications mast (c. 36m high); security fencing; landscaping, new access on to R400 road];
- 220kV overhead line running for c. 5km to the south of the 220kV substation, facilitated by double circuit suspension pylon towers (13 no.; c. 44m high) and strain pylon towers (6 no.; c. 38m high);
- 220kV line-cable interface compound [Including interface tower gantry (c. 20m high); cable sealing ends; security fencing];
- 220kV underground cable connection running for c. 3.4km to the south [With paved and gated

	<p>service road and 12 no. joint bays to facilitate construction and servicing];</p> <ul style="list-style-type: none"> • A 400kV GIS substation located adjacent to the existing Oldstreet-Woodland 400kV overhead line [Including a 400kV GIS building; 220kV GIS building; transformer compound; 2 no. lattice gantries (c. 28m high) to support overhead line connection to 2 no. new loop-in strain towers (c. 32.5m high) on the Oldstreet-Woodland 400kV line; telecommunications mast (c. 36m high); security fencing; landscaping, access off L1010 road]; • 2 no. permanent Peat Deposition Areas will be provided as part of the Electricity Grid Connection – one to the north of the 400kV substation (c. 75,300 sq. m) and one to the south-west of the 220kV substation (c. 50,200 sq. m.); • Tree Replanting Areas (c. 17.5 ha.) are proposed within the planning boundary to compensate for all tree felling requirements associated with the Proposed Development. <p>The application relates to development for the purposes of an activity requiring a license from the Environmental Protection Agency under the Environmental Protection Agency Act 1992, as amended. It also relates to a COMAH establishment and therefore falls under the requirements of the Chemicals Act (Control of Major Accident Hazards Involving Dangerous Substances) Regulations, 2015.</p> <p>An Environmental Impact Assessment Report ('EIAR') and Natura Impact Statement ('NIS') will be submitted with the application.</p>
--	---

10. In the case of mixed development (e.g. residential, commercial, industrial, etc), please provide breakdown of the different classes of development and a breakdown of the gross floor area of each class of development: N/A

Class of Development:	Gross Floor Area in m ²

11. Where the application relates to a building or buildings¹:

Gross floor space of any existing buildings(s) in m ²	5,450 m ²
Gross floor space of proposed works in m ²	16,365 m ²
Gross floor space of work to be retained in m ² (if appropriate)	N/A
Gross floor space of any demolition in m ² (if appropriate)	5,450 m ²

12. In the case of residential development please provide breakdown of residential mix: N/A

Number of	Studio	1 Bed	2 Bed	3 Bed	4 Bed	4 + Bed	Total
Houses							
Apartments							
Number of car-parking spaces to be provided		Existing:	Proposed:			Total:	

13. Social Housing:

Please tick appropriate box:	Yes	No
<i>Is the application an application for permission for development to which Part V of the Planning and Development Act 2000 applies?</i>		✓
<p>If the answer to the above question is “yes” and the development is not exempt (see below), you must provide, as part of your application, details as to how you propose to comply with section 96 of Part V of the Act.</p> <p>If the answer to the above question is “yes” but you consider the development to be exempt by virtue of section 97 of the Planning and Development Act 2000, a copy of the Certificate of Exemption under section 97 must be submitted (or, where an application for a certificate of exemption has been made but has not yet been decided, a copy of the application should be submitted).</p>		

¹ Refer for to Appendix C for Schedule of Area
Application Form for Permission / Approval
in respect of a Strategic Infrastructure Development

If the answer to the above question is “no” by virtue of section 96 (13) of the Planning and Development Act 2000, details indicating the basis on which section 96 (13) is considered to apply to the development should be submitted.

14. Where the application refers to a material change of use of any land or structure or the retention of such a material change of use:

Existing use (or previous use where retention permission is sought)
The land uses within the proposed development site comprise former areas of industrial peat extraction, decommissioning of former industrial peat extraction and agricultural practices in the area of the 400kV substation.
Proposed use (or use it is proposed to retain)
The subject lands will undergo a change of use to a gas fired power plant facility, electrical grid connection, and all associated facilities.
Nature and extent of any such proposed use (or use it is proposed to retain).
The development of a gas fired power plant, electrical grid connection and all associated infrastructure.

15. Development Details:

Please tick appropriate box:	If answer is yes please give details	YES	NO
Does the proposed development involve the demolition of a Protected Structure(s), in whole or in part?			✓
Does the proposed development consist of work to a protected structure and / or its curtilage or proposed protected structure and / or its curtilage?			✓
Does the proposed development consist of work to the exterior of a structure which is located within an architectural conservation area (ACA)?			✓
Does the application relate to development which affects or is close to a monument or place recorded under section 12 of the National Monuments (Amendment) Act, 1994.			✓
Does the application relate to work within or close to a European Site or a Natural Heritage Area?		✓	
Does the development require the preparation of a Natura Impact Statement?		✓	
Does the proposed development require the preparation of an Environmental Impact Assessment Report?		✓	
Do you consider that the proposed development is likely to have significant effects on the environment in a transboundary state?			✓
Does the application relate to a development which comprises or is for the purpose of an activity requiring an integrated pollution prevention and control license		✓	
Does the application relate to a development which comprises or is for the purpose of an activity requiring a waste license?			✓
Do the Major Accident Regulations apply to the proposed development?		✓	
Does the application relate to a development in a Strategic Development Zone?			✓
Does the proposed development involve the demolition of any habitable house?			✓

16. Services:

Proposed Source of Water Supply:
Existing connection: [<input type="checkbox"/>] New Connection: [<input type="checkbox"/>] Public Mains: [<input type="checkbox"/>] Group Water Scheme: [<input type="checkbox"/>] Private Well:[<input checked="" type="checkbox"/>] Other (please specify): Name of Group Water Scheme (where applicable): N/A
Proposed Wastewater Management / Treatment:
Existing: [<input type="checkbox"/>] New: [<input checked="" type="checkbox"/>] Public Sewer: [<input type="checkbox"/>] Conventional septic tank system: [<input type="checkbox"/>] Other on-site treatment system: [<input checked="" type="checkbox"/>] Please Specify: On-site wastewater treatment; Discharging to Yellow River; Refer to submitted Drainage Engineering Assessment Report for detail
Proposed Surface Water Disposal:
Public Sewer / Drain:[<input type="checkbox"/>] Soakpit:[<input type="checkbox"/>] Watercourse: [<input checked="" type="checkbox"/>] Other: [<input type="checkbox"/>] Please specify: Attenuated and treated discharge to the Mongagh River and local drainage channels; Refer to submitted Drainage Engineering Assessment Report for detail.

17. Notices:

Details of public newspaper notice – paper(s) and date of publication
Irish Independent, 08 February 2024 Offaly Topic, 08 February 2024 Refer to Appendix D for copies. Copy of page(s) of relevant newspaper enclosed: Yes: [<input checked="" type="checkbox"/>] No:[<input type="checkbox"/>]
Details of site notice, if any - location and date of erection
Refer to Appendix E for copy of Site Notice; Erected 08 February 2024 at multiple locations (as indicated on the submitted Site Location Maps). Copy of site notice enclosed Yes: [<input checked="" type="checkbox"/>] No:[<input type="checkbox"/>]
Details of other forms of public notification, if appropriate e.g. website
Application Website: www.derrygreenaghpowerplanning.ie Notification letters issued to prescribed bodies.

18. Pre-application Consultation:

Date(s) of statutory pre-application consultations with An Bord Pleanála
Meeting with An Bord Pleanála held 12/05/2023. SID Determination issued 05/07/2023 (ABP-315916-23). Schedule of any other pre application consultations – name of person / body and date of consultation to be provided as appropriate and also details of any general public consultations i.e. methods, dates, venues etc. This can be submitted as a separate schedule with the application form. Enclosed: Yes: [<input checked="" type="checkbox"/>] No:[<input type="checkbox"/>]

Refer to Appendix F and to submitted Environmental Impact Assessment Report (EIAR)

Schedule of prescribed bodies to whom notification of the making of the application has been sent and a sample copy of such notification.

Enclosed:

Yes: [] No:[]

Refer to Appendix F

19. Confirmation Notice:

Copy of Confirmation Notice

Attach a copy of the confirmation notice in relation to the EIA Portal where an EIAR accompanies the application.

Refer to Appendix G

20. Application Fee:

Fee Payable	€100,000
-------------	----------

I hereby declare that, to the best of my knowledge and belief, the information given in this form is correct and accurate and that the application documents being deposited at the planning authority offices, and any other location specified by the Board in pre application consultations, including a website (if any) will be identical to the application documents being deposited with the Board.

Signed: (Applicant or Agent as appropriate)	<i>Scán Breslin</i>
Date:	09 February 2024

General Guidance Note:

The range and format of material required to be compiled / submitted with any application in respect of a proposed strategic infrastructure development shall generally accord with the requirements for a planning application as set out in the Planning and Development Regulations, 2001 to 2018 and those Regulations should therefore be consulted prior to submission of any application.

September 2018

Appendix A – Drawing Register

CLIENT:	Bord na Móna Powergen Limited
PROJECT:	Derrygreenagh Power

DRAWING NUMBER	REVISION No.	DRAWING TITLE	SHEET NOS.	SHEET SIZE	Scale
S7060-8000-0002	1	Drawing Register	1		
S7060-8050-0058	1	Overall Site Location Map	1	A2	1:50000
S7060-8050-0039	1	Overall Site Location Map	1	A2	1:25000
S7060-8050-0040-1	1	Site Location Map (Sheet 1 of 8)	1	A1	1:2500
S7060-8050-0040-2	1	Site Location Map (Sheet 2 of 8)	1	A1	1:2500
S7060-8050-0040-3	1	Site Location Map (Sheet 3 of 8)	1	A1	1:2500
S7060-8050-0040-4	1	Site Location Map (Sheet 4 of 8)	1	A1	1:2500
S7060-8050-0040-5	1	Site Location Map (Sheet 5 of 8)	1	A1	1:2500
S7060-8050-0040-6	1	Site Location Map (Sheet 6 of 8)	1	A1	1:2500
S7060-8050-0040-7	1	Site Location Map (Sheet 7 of 8)	1	A1	1:2500
S7060-8050-0040-8	1	Site Location Map (Sheet 8 of 8)	1	A1	1:2500
S7060-8050-0055-1	1	Proposed Development - Overview Plan (Sheet 1 of 8)	1	A1	1:2500
S7060-8050-0055-2	1	Proposed Development - Overview Plan (Sheet 2 of 8)	1	A1	1:2500
S7060-8050-0055-3	1	Proposed Development - Overview Plan (Sheet 3 of 8)	1	A1	1:2500
S7060-8050-0055-4	1	Proposed Development - Overview Plan (Sheet 4 of 8)	1	A1	1:2500
S7060-8050-0055-5	1	Proposed Development - Overview Plan (Sheet 5 of 8)	1	A1	1:2500
S7060-8050-0055-6	1	Proposed Development - Overview Plan (Sheet 6 of 8)	1	A1	1:2500
S7060-8050-0055-7	1	Proposed Development - Overview Plan (Sheet 7 of 8)	1	A1	1:2500
S7060-8050-0055-8	1	Proposed Development - Overview Plan (Sheet 8 of 8)	1	A1	1:2500
S7060-8050-0042	1	Surface Water Pipe Route	1	A1	1:1250
S7060-8050-0043-1	1	Process Water Discharge Route (Sheet 1 of 4)	1	A1	1:1250
S7060-8050-0043-2	1	Process Water Discharge Route (Sheet 2 of 4)	1	A1	1:1250
S7060-8050-0043-3	1	Process Water Discharge Route (Sheet 3 of 4)	1	A1	1:1250
S7060-8050-0043-4	1	Process Water Discharge Route (Sheet 4 of 4)	1	A1	1:1250
S7060-8050-0044-1	1	Site Drainage Plan Power Plant Area - Main Site (Sheet 1 of 4)	1	A1	1:500
S7060-8050-0044-2	1	Site Drainage Plan 220 kV Compound (Sheet 2 of 4)	1	A1	1:500
S7060-8050-0044-3	1	Site Drainage Plan 400 kV Compound (Sheet 3 of 4)	1	A1	1:500
S7060-8050-0044-4	1	Site Drainage Plan Interface Compound (Sheet 4 of 4)	1	A1	1:500
S7060-8050-0045-1	1	Existing Site Plan (Sheet 1 of 8)	1	A1	1:1250
S7060-8050-0045-2	1	Existing Site Plan (Sheet 2 of 8)	1	A1	1:1250
S7060-8050-0045-3	1	Existing Site Plan (Sheet 3 of 8)	1	A1	1:1250
S7060-8050-0045-4	1	Existing Site Plan (Sheet 4 of 8)	1	A1	1:1250
S7060-8050-0045-5	1	Existing Site Plan (Sheet 5 of 8)	1	A1	1:1250
S7060-8050-0045-6	1	Existing Site Plan (Sheet 6 of 8)	1	A1	1:1250
S7060-8050-0045-7	1	Existing Site Plan (Sheet 7 of 8)	1	A1	1:1250
S7060-8050-0045-8	1	Existing Site Plan (Sheet 8 of 8)	1	A1	1:1250
S7060-8050-0046	1	Site Demolition Plan	1	A1	1:1000
S7060-8050-0050	1	Power Plant Area - Main Site Plan	1	A1	1:1250
S7060-8050-0054-1	1	Existing Elevations Admin Building (1) (Sheet 1 of 6)	1	A1	1:100
S7060-8050-0054-2	1	Existing Elevations Boiler House Building (2) (Sheet 2 of 6)	1	A1	1:100
S7060-8050-0054-3	1	Existing Elevations Workshop Building (3) (Sheet 3 of 6)	1	A1	1:200
S7060-8050-0054-4	1	Existing Elevations Workshop Building (4) (Sheet 4 of 6)	1	A1	1:100
S7060-8050-0054-5	1	Existing Elevations Water Tank (5) (Sheet 5 of 6)	1	A1	1:100
S7060-8050-0054-6	1	Existing Elevations Storage Unit (6) (Sheet 6 of 6)	1	A1	1:100
S7060-8050-0057	1	Power Plant Area - Main Site Elevations	1	A1	1:100
S7060-8050-0037	1	Power Plant - Main Site Sections	1	A0	1:500

CLIENT:	Bord na Móna Powergen Limited
PROJECT:	Derrygreenagh Power

DRAWING NUMBER	REVISION No.	DRAWING TITLE	SHEET NOS.	SHEET SIZE	Scale
S7060-8050-0007	1	Admin Building Ground & First Floor Plan	1	A1	1:100
S7060-8050-0008	1	Admin Building Elevations & Sections	1	A1	1:125
S7060-8050-0001	1	Air Cooled Condenser Plan	1	A1	1:200
S7060-8050-0002	1	Air Cooled Condenser Elevations	1	A1	1:200
S7060-8050-0003	1	Air Cooled Condenser Section	1	A1	1:200
S7060-8050-0027	1	Air Cooled Condenser - Motor Control Centre Building Plan, Elevations and Sections	1	A1	Multiple
S7060-8050-0024	1	Water Treatment Plant Plan, Elevations & Sections	1	A1	1:125
S7060-8050-0016	1	Workshop & Stores Plan	1	A1	1:200
S7060-8050-0017	1	Workshop & Stores Elevations & Sections	1	A1	1:150
S7060-8050-0009	1	Gas Plant AGI Buildings Plan	1	A1	1:200
S7060-8050-0010	1	Gas Plant AGI Buildings Elevations	1	A1	1:125
S7060-8050-0011	1	Gas Plant AGI Buildings Sections	1	A1	1:50
S7060-8050-0030	1	Gas Receiving Facility Plan, Elevations and Sections	1	A1	1:200
S7060-8050-0026	1	Auxiliary Boiler Building Plan, Elevations & Sections	1	A1	1:200
S7060-8050-0018	1	Secondary Fuel Storage Plan	1	A1	1:125
S7060-8050-0019	1	Secondary Fuel Storage Elevations & Sections	1	A1	1:200
S7060-8050-0035	1	Ancillary Coolers & Transformers	1	A1	1:200
S7060-8050-0036	1	Caustic, Acid and Ammonia Storage Area	1	A1	1:100
S7060-8050-0028	1	Fuel Gas Performance Heater Room Plan, Elevations and Sections	1	A1	1:100
S7060-8050-0029	1	Boiler Feedpump Building Plan, Elevations and Sections	1	A1	1:100
S7060-8050-0051	1	Process Waste Water System	1	A3	1:200
S7060-8050-0004	1	CCGT Plan	1	A1	1:200
S7060-8050-0005	1	CCGT North & South Elevations	1	A1	1:250
S7060-8050-0006	1	CCGT East & West Elevations	1	A1	1:250
S7060-8050-0038	1	CCGT Cross Sections	1	A1	1:100
S7060-8050-0012	1	OCGT Plan	1	A1	1:200
S7060-8050-0013	1	OCGT Northern & South Elevations	1	A1	1:200
S7060-8050-0014	1	OCGT East & West Elevations	1	A1	1:200
S7060-8050-0015	1	Section Through OCGT	1	A1	1:200
S7060-8050-0025	1	Fire/Raw Water & Demin Tank Plan, Elevations & Section	1	A1	1:250
S7060-8050-0032	1	Electrical Rooms Plan Elevations & Sections	1	A1	1:200
S7060-8050-0020	1	Lube Oil Store Plan	1	A1	1:50
S7060-8050-0021	1	Lube Oil store Elevations & Sections	1	A1	1:75
S7060-8050-0033	1	Propane Store Plan Elevations, Section	1	A1	1:25
S7060-8050-0022	1	Firewater & Raw Water Pumphouse Plan	1	A1	1:50
S7060-8050-0023	1	Firewater & Raw Water Pumphouse Elevations & Sections	1	A1	1:50
S7060-8050-0031	1	Auxiliaries Building Plan Elevation and Sections	1	A1	1:100
S7060-8050-0034	1	Pipe Gantry Typical Section	1	A1	1:50
S7060-8050-0056	1	Admin Car Park	1	A3	1:250
S7060-8050-0052	1	Rising Arm Barrier Access	1	A3	1:25
S7060-8050-0053	1	Sliding Gate Access	1	A3	1:25
BNM-DPS-E-1001	00	220 kV Overhead Line Structure	1	A1	Multiple
BNM-DPS-E-1002	00	220 kV Strain Tower	1	A1	1:100
BNM-DPS-E-1003	00	400kV Strain Tower	1	A1	1:125
BNM-DPS-E-1004	00	220 kV Joint Bay	1	A1	1:20
BNM-DPS-E-1005	00	220 kV Line Cable Interface Compound	1	A1	Multiple

CLIENT:	Bord na Móna Powergen Limited
PROJECT:	Derrygreenagh Power

DRAWING NUMBER	REVISION No.	DRAWING TITLE	SHEET NOS.	SHEET SIZE	Scale
BNM-DPS-E-2000	00	220 kV Substation Plan Views	1	A1	1:300
BNM-DPS-E-2001	00	Derrygreenagh 220kV Substation Elevation Views Sh No. 1 of 2	1	A1	1:200
BNM-DPS-E-2001	00	Derrygreenagh 220kV Substation Elevation Views Sh No. 2 of 2	1	A1	1:200
BNM-DPS-E-2002	00	400kV Substation Plan View	1	A1	1:250
BNM-DPS-E-2003	00	400kV Substation Elevation Views Sh No. 1 of 2	1	A1	1:250
BNM-DPS-E-2003	00	400kV Substation Elevation Views Sh No. 2 of 2	1	A1	1:250
BNM-DPS-E-2004	00	GIS Buildings Plan, Elevation & Sections Sh No. 1 of 3	1	A1	1:100
BNM-DPS-E-2004	00	GIS Buildings Plan, Elevation & Sections Sh No. 2 of 3	1	A1	1:100
BNM-DPS-E-2004	00	GIS Buildings Plan, Elevation & Sections Sh No. 3 of 3	1	A1	1:100
BNM-DPS-E-2005	00	Substation Compound Details Sh No. 1 of 2	1	A1	Multiple
BNM-DPS-E-2005	00	Substation Compound Details Sh No. 2 of 2	1	A1	Multiple
BNM-DPS-E-2006	00	Typical Drainage Details Sh No. 1 of 2	1	A1	Multiple
BNM-DPS-E-2006	00	Typical Drainage Details Sh No. 2 of 2	1	A1	Multiple
BNM-DPS-E-2007	00	Palisade fence and gate details	1	A1	NTS
BNM-DPS-E-2008	00	Telecoms Tower	1	A1	1:100
BNM-DPS-E-2010	00	IPP Control Building	1	A1	1:100
BNM-DPS-E-2011	00	Excavate and Replace Access Track - Typical Section	1	A1	1:30
BNM-DPS-E-2012	00	Floating Access Track - Typical Section	1	A1	1:30
BNM-DPS-E-2013	00	Upgrade of Existing Excavated Access Track - Typical Section	1	A1	1:30
BNM-DPS-E-2014	00	Upgrade of Existing Floating Access Track - Typical Section	1	A1	1:20
BNM-DPS-E-2015	00	Property Boundary Timber Post & Rail Fence	1	A1	1:200
XDC-CBL-STND-F-001	00	Standard 3rd Party Crossing 200mm OD HV Ducts Index Sheet	1	A3	NTS
XDC-CBL-STND-F-001	00	Standard 3rd Party Crossing Above In Full Flat Formation 200mm OD HV Ducts	1	A3	NTS
XDC-CBL-STND-F-001	00	Standard 3rd Party Crossing Above In Trefoil Formation 200mm OD HV Ducts	1	A3	NTS
XDC-CBL-STND-F-002	00	Standard 3rd Party Crossing 200mm Index Sheet	1	A3	NTS
XDC-CBL-STND-F-002	00	Standard 3rd Party Crossing 200mm Below in Full Flat Formation	1	A3	NTS
XDC-CBL-STND-F-002	00	Standard 3rd Party Crossing 200mm below in Trefoil Formation	1	A3	NTS
XDC-CBL-STND-F-007	00	Standard Cable Trench through Peat Index Sheet	1	A3	NTS
XDC-CBL-STND-F-007	00	Indicative Section through Solid Cable Trench (Floating Road) Peat Depth <2.5m	1	A3	NTS
XDC-CBL-STND-F-007	00	Indicative Section through Floating Road Upgraded to Solid Peat Depth <2.5m	1	A3	NTS
XDC-CBL-STND-F-007	00	Indicative Section through Floating Road Peat Depth >2.5m	1	A3	NTS
XDC-CBL-STND-F-008	00	Cross Sections Index Sheet	1	A3	NTS
XDC-CBL-STND-F-008	00	Trench Cross Sections 200kV Trefoil Formation	1	A3	NTS
XDC-CBL-STND-F-008	00	Trench Cross Sections 200kV Flat Formation	1	A3	NTS
XDC-CBL-STND-F-008	00	Trench Cross Sections 200kV Full Flat Formation	1	A3	NTS
XDC-CBL-STND-F-008	00	Trench Cross Sections 200kV Trefoil Formation with ECC Duct	1	A3	NTS
XDC-CBL-STND-F-008	00	Trench Cross Sections 200kV Flat Formation with ECC Duct	1	A3	NTS
XDC-CBL-STND-F-008	00	Trench Cross Sections 200kV Full Flat Formation with ECC Duct	1	A3	NTS

Appendix B – Letters of Consent

Strategic Infrastructure Development Section,
An Bord Pleanála,
64 Marlborough Street,
Dublin 1.

**RE: Bord na Móna Powergen Limited, Planning Application re Development of
Derrygreenagh Power situated at Derrygreenagh, Co. Offaly**

We, Bord na Móna Biomass Limited, of Main Street, Newbridge, Co. Kildare, W12 XR59, hereby confirm that we are the freehold and beneficial owners of the lands delineated by the red line on the map (ref. BNM-PG-22-11-59) attached hereto. All the foregoing lands contained within the townlands of Knockdrin, Derrygreenagh, Derryarkin, Derryiron, Ballybeg, Coolcor, Barrysbrook, Clonin, Togher, Coole, in the county of Offaly

We provide herewith our written consent to Bord na Móna Powergen Limited to include our lands as described above in a planning application pursuant to section 37E of the Planning and Development Act, as amended, for development of Derrygreenagh Power electricity generating station, tailed GIS substation, hybrid transmission of overhead line and underground cable, new loop-in 220/400kV GIS substation and all associated infrastructure at Derrygreenagh and other adjacent townlands in the County of Offaly.

Yours Sincerely,

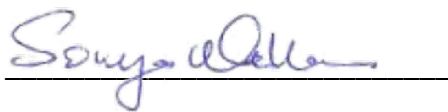

Name: Sonya Mallon

Date: 30 January 2024

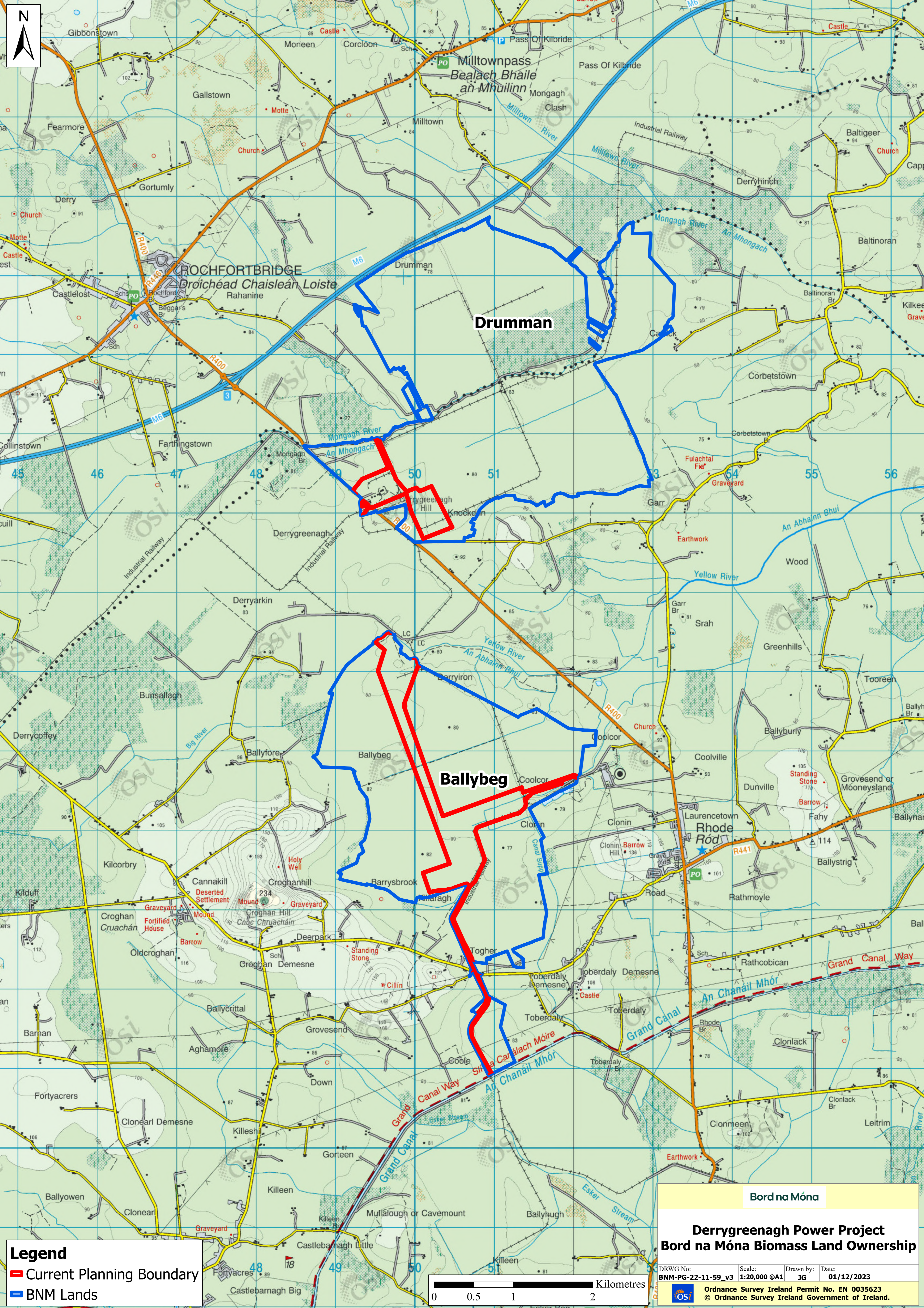
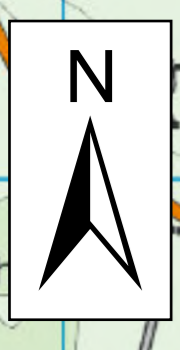

Legend

- ▬ Current Planning Boundary
- ▬ BNM Lands

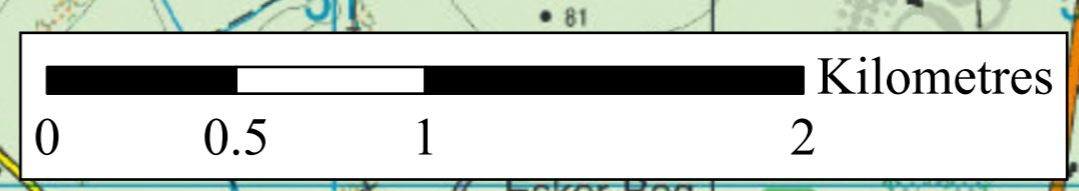

Bord na Móna

**Derrygreenagh Power Project
Bord na Móna Biomass Land Ownership**

DRWG No:	Scale:	Drawn by:	Date:
BNM-PG-22-11-59_v3	1:20,000 @A1	JG	01/12/2023

Ordnance Survey Ireland Permit No. EN 0035623
 © Ordnance Survey Ireland Government of Ireland.

Strategic Infrastructure Development Section,
An Bord Pleanála,
64 Marlborough Street,
Dublin 1.

**RE: Bord na Móna Powergen Limited, Planning Application re Development of
Derrygreenagh Power situated at Derrygreenagh, Co. Offaly**

We, Bord na Móna Energy Limited, of Main Street, Newbridge, Co. Kildare, W12 XR59, hereby confirm that we are the freehold and beneficial owners of the lands delineated by the red line on the map (ref. BNM-PG-22-11-57)) attached hereto. All the foregoing lands contained within the townlands of Knockdrin, Derrygreenagh, Derryiron, in the county of Offaly

We provide herewith our written consent to Bord na Móna Powergen Limited to include our lands as described above in a planning application pursuant to section 37E of the Planning and Development Act, as amended, for development of Derrygreenagh Power electricity generating station, tailed GIS substation, hybrid transmission of overhead line and underground cable, new loop-in 220/400kV GIS substation and all associated infrastructure at Derrygreenagh and other adjacent townlands in the County of Offaly.

Yours Sincerely,

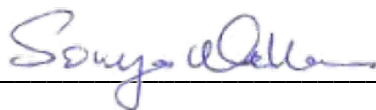

Name: Sonya Mallon

Date: 30 January 2024

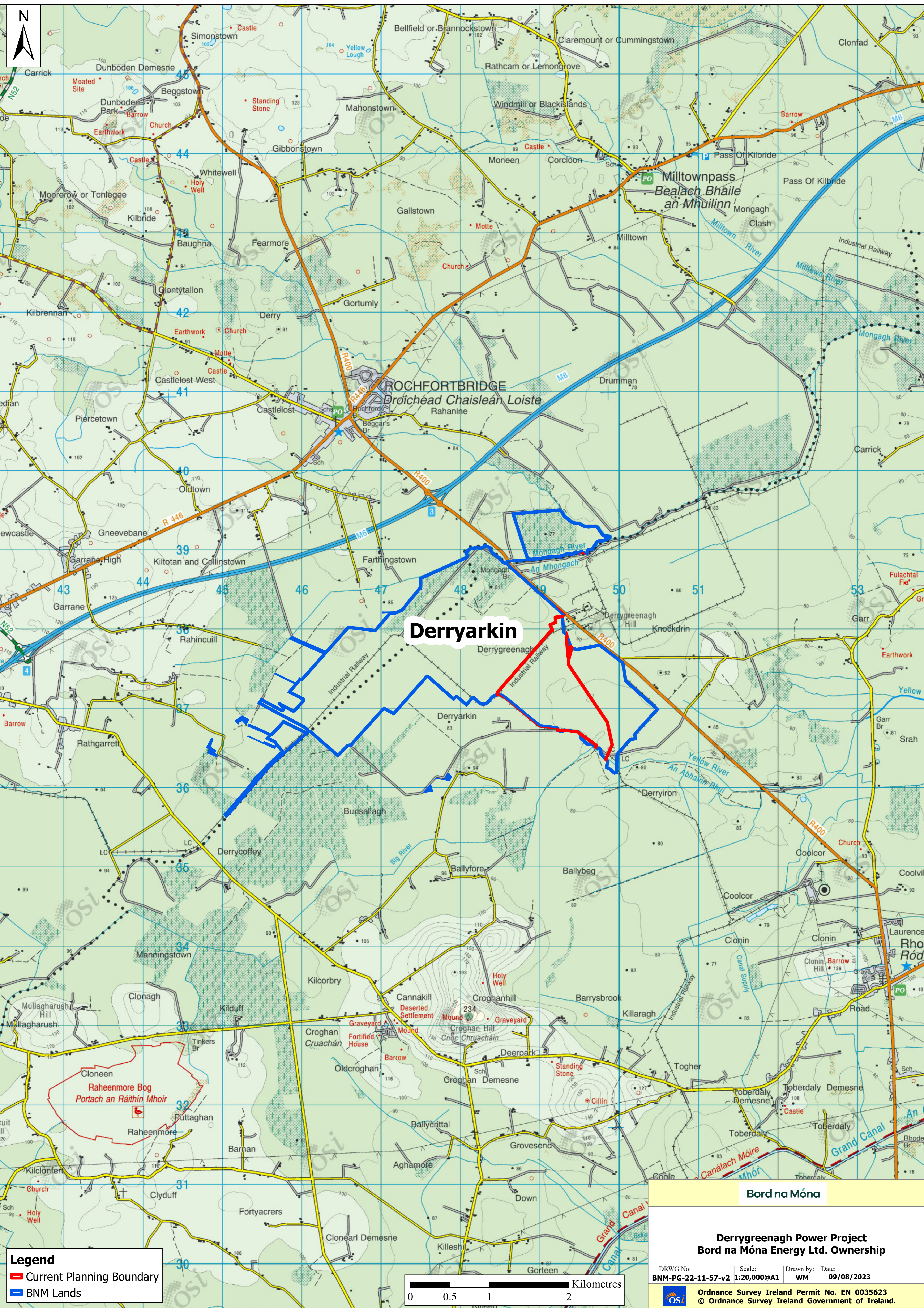

Derryarkin

Legend

- Current Planning Boundary
- BNM Lands



Bord na Móna

Derrygreenagh Power Project
Bord na Móna Energy Ltd. Ownership

DRWG No:	Scale:	Drawn by:	Date:
BNM-PG-22-11-57-v2	1:20,000@A1	WM	09/08/2023

Ordnance Survey Ireland Permit No. EN 0035623
© Ordnance Survey Ireland Government of Ireland.

Matthew and Mary Conway,
Coole,
Croghan,
Rhode,
County Offaly,
R35 DD21.

Strategic Infrastructure Development Section,
An Bord Pleanála,
64 Marlborough Street,
Dublin 1.

**RE: Bord na Móna Powergen Limited, Planning Application re Development of
Derrygreenagh Power situated at Derrygreenagh, Co. Offaly**

Dear Sir / Madam,

We, Matthew and Mary Conway, of Coole, Croghan, Rhode, County Offaly, R35 DD21, hereby confirm that we are the freehold owner of the lands edged blue on the attached map (ref. BNM-PG-22-11-03) contained in Folio OY2577.

We provide herewith our written consent to Bord na Móna Powergen Limited to include our lands as described above in a planning application pursuant to section 37E of the Planning and Development Act, as amended, for development of Derrygreenagh Power electricity generating station, tailed GIS substation, hybrid transmission of overhead line and underground cable, new loop-in 220/400kV GIS substation and all associated infrastructure at Derrygreenagh and other adjacent townlands in the County of Offaly.

Yours sincerely,

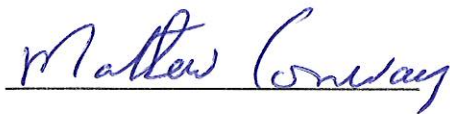

Name: Matthew Conway

Date: 18/6/2023



Name: Mary Conway

Date: 18/6/2023

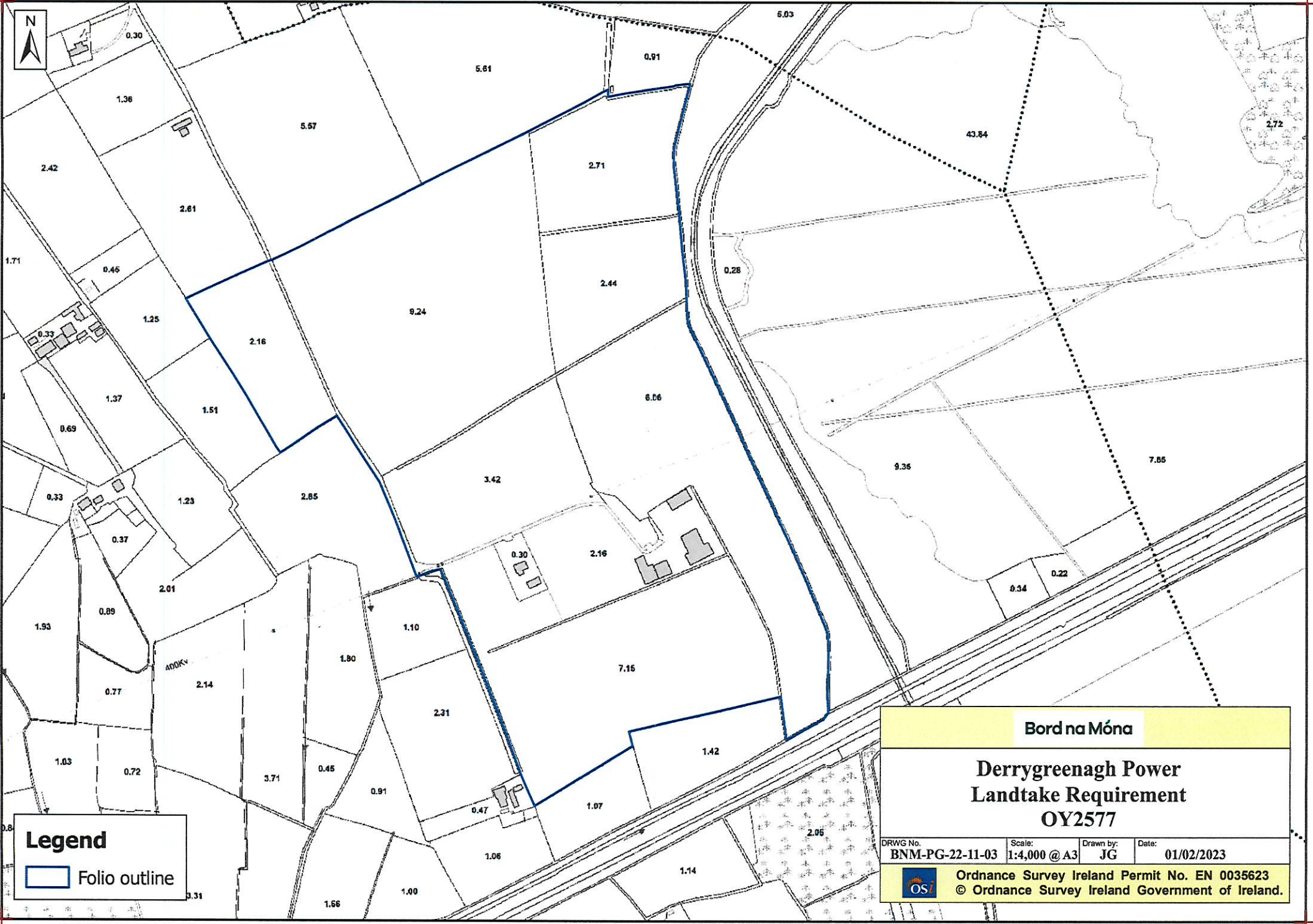

Legend

 Folio outline

Bord na Móna

**Derrygreenagh Power
Landtake Requirement
OY2577**

DRWG No. BNM-PG-22-11-03	Scale: 1:4,000 @ A3	Drawn by: JG	Date: 01/02/2023
-----------------------------	------------------------	-----------------	---------------------



Ordnance Survey Ireland Permit No. EN 0035623
© Ordnance Survey Ireland Government of Ireland.

Matthew and Mary Conway,
Coole,
Croghan,
Rhode,
County Offaly,
R35 DD21.

Strategic Infrastructure Development Section,
An Bord Pleanála,
64 Marlborough Street,
Dublin 1.

**RE: Bord na Móna Powergen Limited, Planning Application re Development of
Derrygreenagh Power situated at Derrygreenagh, Co. Offaly**

Dear Sir / Madam,

We, Matthew and Mary Conway of Coole, Croghan, Rhode, Co. Offaly, R35 DD21 hereby confirm that we are in occupation of the lands edged blue on the attached map (the Property) (Ref. BNM- PG-22-11-04) and intend to lodge an application for adverse possession in relation to the Property with Land Registry Services of Property Registration of Ireland (PRAI) to perfect the title as freehold owners.

We hereby provide written consent to Bord na Móna Powergen Limited to include the Property in a planning application pursuant to section 37E of the Planning and Development Act, as amended, for development of Derrygreenagh Power electricity generating station, tailed GIS substation, hybrid transmission of overhead line and underground cable, new loop-in 220/400kV GIS substation and all associated infrastructure at Derrygreenagh and other adjacent townlands in the County of Offaly.

Yours sincerely,

Matthew Conway

Name: Matthew Conway

Mary Conway

Name: Mary Conway

Date: 18/6/2023

Date: 18/6/2023

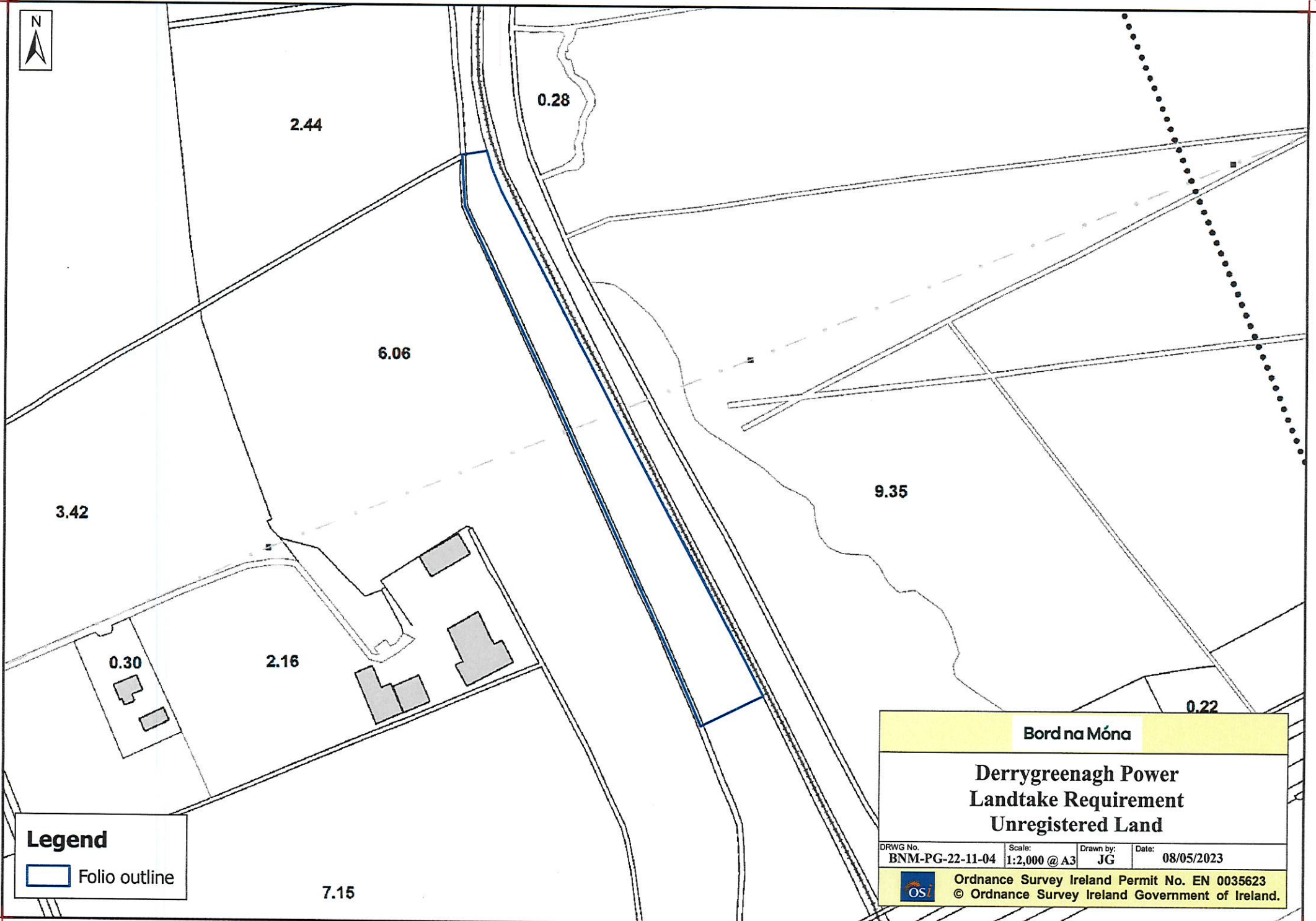

Strategic Infrastructure Development Section
An Bord Pleanála
64 Marlborough St
Dublin 1

Date.
19 September 2023

Our Ref.
AK/PGDEV00704

RE: Planning Application re : Development of Derrygreenagh Power situated at Derrygreenagh, Co Offaly.

Dear Sirs,

We, Bord Na Móna Powergen Ltd of Main St, Newbridge, Co Kildare confirm that we are the party entitled to be registered freehold owners of part of the lands situate at Coole, Croghan, Rhode, Co Offaly comprised in Folio OY32742F (formerly OY16198), as per the map attached hereto referenced BNM-PG-22-11-05, the subject matter of dealing number D2023LR097832H, currently pending registration in the PRAI.

Yours faithfully,



DocuSigned by:

C350C5D4C0CF441...

Bord Na Móna Powergen Ltd



0.34

Legend

-  Landtake
-  Folio outline

Bord na Móna

**Derrygreenagh Power
Landtake Requirement
OY32742F (Dealing No. D2023LR097832H)**

DRWG No. BNM-PG-22-11-05_v2	Scale: 1:1,000 @ A3	Drawn by: JG	Date: 22/09/2023
--------------------------------	------------------------	-----------------	---------------------



Ordnance Survey Ireland Permit No. EN 0035623
© Ordnance Survey Ireland Government of Ireland.

Appendix C – Newspaper Notices

(Note: Published pages included with physical submission)

Planning and Development Act, 2000 (As Amended)

Notice of Direct Planning Application to An Bord Pleanála in respect of a Strategic Infrastructure Development

Offaly County Council

In accordance with Section 37E of the Planning and Development Act 2000 (as amended), Bord na Móna Powergen Limited gives notice of its intention to make an application to An Bord Pleanála for a 10-year planning permission to develop a Combined Cycle Gas Turbine ('CCGT') and Open Cycle Gas Turbine ('OCGT') Thermal Power Plant, Electricity Grid Connection including 2 no. substations, and associated buildings, plant, site works, services and ancillary development on land within the townlands of Knockdrin, Derrygreenagh, Derryarkin, Derryiron, Ballybeg, Coolcor, Barrybrook, Clonin, Togher and Coole, Co. Offaly.

The Proposed Development will encompass a Power Plant Area and an Electricity Grid Connection.

The development of the Power Plant Area will include the following:

- Demolition of existing buildings at the Derrygreenagh Works site (Including office building, boiler house, workshops, water tank and storage unit);
- Construction of CCGT power plant (570MW) [Including turbine hall and associated buildings, air cooled condensers ('ACC'), Heat Recovery Steam Generator ('HRSG'), air intake, emissions stack (60m high) with Continuous Emissions Monitoring System ('CEMS') and platform];
- Ancillary coolers;
- Fuel gas performance heating room;
- Generator transformer and unit auxiliary transformer;
- OCGT power plant (140MW) [Including turbine enclosures, air intakes, fin fan coolers, emissions stack (45m high), electrical rooms, main transformer];
- Secondary fuel storage tanks and unloading area [Including unloading layby, 2 no. fuel storage tanks, fuel pumping and cleaning plant, fuel forwarding building];
- 2 no. water abstraction boreholes;
- Raw water storage tank;
- 2 no. demineralised water storage tanks;
- Water treatment plant;
- Administration building and staff car park;
- Wastewater treatment plant;
- Workshop and stores building;
- Process water treatment plant;
- Gas Above Ground Installation ('AGI') compound [Including regulator building, instrumentation kiosks, palisade fencing];
- Gas receiving facility [Including gas compressor building, fin fan coolers, pressure reducing station];
- Drainage infrastructure [Including surface water attenuation tank, surface water discharge pipeline (Discharging to the Mongagh River), treated process and wastewater discharge pipeline (Discharging to the Yellow River)];
- A new site access from the R400 road;
- All internal access roads;
- Security fencing and gates;
- Landscaping;

- Site works and services;
- All ancillary infrastructure and plant [Including firefighting systems, fire water pumphouse, raw water pumphouse, emergency diesel generator, propane stores, chemical storage tanks and pumphouse, lube oil storage building, silencers, vents, drains, safety valves, lighting, and pipe gantries];
- A permanent Peat and Spoil Deposition Area ('PDA') of approx. 225,000 sq. m. will be located to the south-east of the Power Plant Area.

The development of the Electricity Grid Connection will include the following:

- A 220kV substation located to the west of the Power Plant Area and R400 road [Hybrid gas insulated switchgear ('GIS')/air insulated switchgear ('AIS') substation design including switchgear building; control room building; transformer bays; 2. no. lattice gantries (c. 20m high) to support overhead line connection; telecommunications mast (c. 36m high); security fencing; landscaping, new access on to R400 road];
- 220kV overhead line running for c. 5km to the south of the 220kV substation, facilitated by double circuit suspension pylon towers (13 no.; c. 44m high) and strain pylon towers (6 no.; c. 38m high);
- 220kV line-cable interface compound [Including interface tower gantry (c. 20m high); cable sealing ends; security fencing];
- 220kV underground cable connection running for c. 3.4km to the south [With paved and gated service road and 12 no. joint bays to facilitate construction and servicing];
- A 400kV GIS substation located adjacent to the existing Oldstreet-Woodland 400kV overhead line [Including a 400kV GIS building; 220kV GIS building; transformer compound; 2 no. lattice gantries (c. 28m high) to support overhead line connection to 2 no. new loop-in strain towers (c. 32.5m high) on the Oldstreet-Woodland 400kV line; telecommunications mast (c. 36m high); security fencing; landscaping, access off L1010 road];
- 2 no. permanent Peat Deposition Areas will be provided as part of the Electricity Grid Connection – one to the north of the 400kV substation (c. 75,300 sq. m) and one to the south-west of the 220kV substation (c. 50,200 sq. m.);
- Tree Replanting Areas (c. 17.5 ha.) are proposed within the planning boundary to compensate for all tree felling requirements associated with the Proposed Development.

The application relates to development for the purposes of an activity requiring a license from the Environmental Protection Agency under the Environmental Protection Agency Act 1992, as amended. It also relates to a COMAH establishment and therefore falls under the requirements of the Chemicals Act (Control of Major Accident Hazards Involving Dangerous Substances) Regulations, 2015.

An Environmental Impact Assessment Report ('EIAR') and Natura Impact Statement ('NIS') will be submitted with the application.

The planning application, including the EIAR and NIS, may be inspected free of charge or purchased on payment of a specified fee (which shall not exceed the reasonable cost of making a copy) during public opening hours for a period of seven weeks commencing on 16 February 2024 at the following locations:

- The offices of An Bord Pleanála, 64 Marlborough Street, Dublin 1, D01 V902;
- The offices of Offaly County Council, Áras an Chontae, Charleville Road, Tullamore, Co. Offaly, R35 F893;

The planning application and EIAR may also be viewed or downloaded on the following website: www.derrygreenaghpowerplanning.ie .

Submissions or observations may be made only to An Bord Pleanála (“the Board”), 64 Marlborough Street, Dublin 1, D01 V902; or via the Board’s website, www.pleanala.ie/en-ie/observations, during the aforementioned period of seven weeks relating to:

- i. The implications of the proposed development for proper planning and sustainable development; and
- ii. The likely effects on the environment of the proposed development; and
- iii. The likely significant effects of the proposed development on a European site, if carried out.

Any submissions or observations must be accompanied by a fee of €50 (except for certain prescribed bodies) and must be received by the Board not later than 5.30 p.m. on 5 April 2024. Such submissions or observations must also include the following information:

- The name of the person making the submission or observation, the name of the person acting on his or her behalf, if any, and the address to which any correspondence relating to the application should be sent; and
- The subject matter of the submission or observation; and
- The reasons, considerations and arguments on which the submission or observation is based in full (Article 217 of the Planning and Development Regulations 2001, as amended, refers).

Any submissions or observations which do not comply with the above requirements cannot be considered by the Board.

The Board may, at its absolute discretion, hold an oral hearing on the application (refer to ‘A Guide to Public Participation in Strategic Infrastructure Development’ at www.pleanala.ie).

The Board may, in respect of an application for permission/approval, decide to:

- a) (i) grant the permission/approval; or
(ii) make such modifications to the proposed development as it specifies in its decision and grant permission/approval in respect of the proposed development as so modified; or
(iii) grant permission/approval in respect of part of the proposed development (with or without specified modifications of the foregoing kind), and any of the above decisions may be subject to or without conditions; or
- b) Refuse permission to grant the permission/approval.

Any enquiries relating to the application process should be directed to the Strategic Infrastructure Development Section of An Bord Pleanála (Tel. 01-8588100).

A person may question the validity of any such decision of the Board by way of an application for judicial review, under Order 84 of the Rule of the Superior Courts (S.I. No. 15 of 1986, as amended by S.I. No. 691 of 2011), in accordance with Section 50 of the Planning and Development Act 2000, as amended. Practical information on the review mechanism can be accessed on the Board’s website (www.pleanala.ie) under the following heading: Legal Notices – Judicial Review Notice. This information is also available on the Citizens Information Service website (www.citizensinformation.ie).

Appendix D – Site Notice

SITE NOTICE

Planning and Development Act, 2000 (As Amended)

Notice of Direct Planning Application to An Bord Pleanála in respect of a Strategic Infrastructure Development

Offaly County Council

In accordance with Section 37E of the Planning and Development Act 2000 (as amended), Bord na Móna Powergen Limited gives notice of its intention to make an application to An Bord Pleanála for a 10-year planning permission to develop a Combined Cycle Gas Turbine ('CCGT') and Open Cycle Gas Turbine ('OCGT') Thermal Power Plant, Electricity Grid Connection including 2 no. substations, and associated buildings, plant, site works, services and ancillary development on land within the townlands of Knockdrin, Derrygreenagh, Derryarkin, Derryiron, Ballybeg, Coolcor, Barrysbrook, Clonin, Togher and Coole, Co. Offaly.

The Proposed Development will encompass a Power Plant Area and an Electricity Grid Connection.

The development of the Power Plant Area will include the following:

- Demolition of existing buildings at the Derrygreenagh Works site (Including office building, boiler house, workshops, water tank and storage unit);
- Construction of CCGT power plant (570MW) [Including turbine hall and associated buildings, air cooled condensers ('ACC'), Heat Recovery Steam Generator ('HRSG'), air intake, emissions stack (60m high) with Continuous Emissions Monitoring System ('CEMS') and platform];
- Ancillary coolers;
- Fuel gas performance heating room;
- Generator transformer and unit auxiliary transformer;
- OCGT power plant (140MW) [Including turbine enclosures, air intakes, fin fan coolers, emissions stack (45m high), electrical rooms, main transformer];
- Secondary fuel storage tanks and unloading area [Including unloading layby, 2 no. fuel storage tanks, fuel pumping and cleaning plant, fuel forwarding building];
- 2 no. water abstraction boreholes;
- Raw water storage tank;
- 2 no. demineralised water storage tanks;
- Water treatment plant;

- Administration building and staff car park;
- Wastewater treatment plant;
- Workshop and stores building;
- Process water treatment plant;
- Gas Above Ground Installation ('AGI') compound [Including regulator building, instrumentation kiosks, palisade fencing];
- Gas receiving facility [Including gas compressor building, fin fan coolers, pressure reducing station];
- Drainage infrastructure [Including surface water attenuation tank, surface water discharge pipeline (Discharging to the Mongagh River), treated process and wastewater discharge pipeline (Discharging to the Yellow River)];
- A new site access from the R400 road;
- All internal access roads;
- Security fencing and gates;
- Landscaping;
- Site works and services;
- All ancillary infrastructure and plant [Including firefighting systems, fire water pumphouse, raw water pumphouse, emergency diesel generator, propane stores, chemical storage tanks and pumphouse, lube oil storage building, silencers, vents, drains, safety valves, lighting, and pipe gantries];
- A permanent Peat and Spoil Deposition Area ('PDA') of approx. 225,000 sq. m. will be located to the south-east of the Power Plant Area.

The development of the Electricity Grid Connection will include the following:

- A 220kV substation located to the west of the Power Plant Area and R400 road [Hybrid gas insulated switchgear ('GIS')/air insulated switchgear ('AIS') substation design including switchgear building; control room building; transformer bays; 2. no. lattice gantries (c. 20m high) to support overhead line connection; telecommunications mast (c. 36m high); security fencing; landscaping, new access on to R400 road];
- 220kV overhead line running for c. 5km to the south of the 220kV substation, facilitated by double circuit suspension pylon towers (13 no.; c. 44m high) and strain pylon towers (6 no.; c. 38m high);
- 220kV line-cable interface compound [Including interface tower gantry (c. 20m high); cable sealing ends; security fencing];

- 220kV underground cable connection running for c. 3.4km to the south [With paved and gated service road and 12 no. joint bays to facilitate construction and servicing];
- A 400kV GIS substation located adjacent to the existing Oldstreet-Woodland 400kV overhead line [Including a 400kV GIS building; 220kV GIS building; transformer compound; 2 no. lattice gantries (c. 28m high) to support overhead line connection to 2 no. new loop-in strain towers (c. 32.5m high) on the Oldstreet-Woodland 400kV line; telecommunications mast (c. 36m high); security fencing; landscaping, access off L1010 road];
- 2 no. permanent Peat Deposition Areas will be provided as part of the Electricity Grid Connection – one to the north of the 400kV substation (c. 75,300 sq. m) and one to the south-west of the 220kV substation (c. 50,200 sq. m.);
- Tree Replanting Areas (c. 17.5 ha.) are proposed within the planning boundary to compensate for all tree felling requirements associated with the Proposed Development.

The application relates to development for the purposes of an activity requiring a license from the Environmental Protection Agency under the Environmental Protection Agency Act 1992, as amended. It also relates to a COMAH establishment and therefore falls under the requirements of the Chemicals Act (Control of Major Accident Hazards Involving Dangerous Substances) Regulations, 2015.

An Environmental Impact Assessment Report ('EIAR') and Natura Impact Statement ('NIS') will be submitted with the application.

The planning application and EIAR may be inspected free of charge or purchased on payment of a specified fee (which shall not exceed the reasonable cost of making a copy) during public opening hours for a period of seven weeks commencing on 16 February 2024 at the following locations:

- The offices of An Bord Pleanála, 64 Marlborough Street, Dublin 1, D01 V902;
- The offices of Offaly County Council, Áras An Chontae, Charleville Road, Tullamore, Offaly, R35 F893;

The planning application and EIAR may also be viewed or downloaded on the following website: www.derrygreenaghpowerplanning.ie .

Submissions or observations may be made only to An Bord Pleanála ("the Board"), 64 Marlborough Street, Dublin 1, D01 V902; or via the Board's website, www.pleanala.ie/en-ie/observations, during the aforementioned period of seven weeks relating to:

- i. The implications of the proposed development for proper planning and sustainable development; and
- ii. The likely effects on the environment of the proposed development; and
- iii. The likely significant effects of the proposed development on a European site, if carried out.

Any submissions or observations must be accompanied by a fee of €50 (except for certain prescribed bodies) and must be received by the Board not later than 5.30 p.m. on 05 April 2024. Such submissions or observations must also include the following information:

- The name of the person making the submission or observation, the name of the person acting on his or her behalf, if any, and the address to which any correspondence relating to the application should be sent; and

- The subject matter of the submission or observation; and
- The reasons, considerations and arguments on which the submission or observation is based in full (Article 217 of the Planning and Development Regulations 2001, as amended, refers).

Any submissions or observations which do not comply with the above requirements cannot be considered by the Board.

The Board may, at its absolute discretion, hold an oral hearing on the application (refer to 'A Guide to Public Participation in Strategic Infrastructure Development' at www.pleanala.ie).

The Board may, in respect of an application for permission/approval, decide to:

- a) (i) grant the permission/approval; or
(ii) make such modifications to the proposed development as it specifies in its decision and grant permission/approval in respect of the proposed development as so modified; or
(iii) grant permission/approval in respect of part of the proposed development (with or without specified modifications of the foregoing kind), and any of the above decisions may be subject to or without conditions; or
- b) Refuse permission to grant the permission/approval.

Any enquiries relating to the application process should be directed to the Strategic Infrastructure Development Section of An Bord Pleanála (Tel. 01-8588100).

A person may question the validity of any such decision of the Board by way of an application for judicial review, under Order 84 of the Rule of the Superior Courts (S.I. No. 15 of 1986, as amended by S.I. No. 691 of 2011), in accordance with Section 50 of the Planning and Development Act 2000, as amended. Practical information on the review mechanism can be accessed on the Board's website (www.pleanala.ie) under the following heading: Legal Notices – Judicial Review Notice. This information is also available on the Citizens Information Service website (www.citizensinformation.ie).

Signed: 

Sean Breslin, Gravis Planning, 41 Baggot Street Lower, Dublin 2, D02 NN67 (Agent on behalf of the Applicant)

Date of Erection of Site Notice: 08 February 2024

Appendix E – Schedule of Pre-Application Consultations

Appendix F – Schedule of Pre-Application Consultations

- Public Consultation Event, Rhode Parish Hall, Rhode, Co. Offaly, 28/03/2023
- Public Consultation Event, St Joseph's Parish Hall, Rochfortbridge, Co. Westmeath, 29/03/2023
- Public Consultation Event, Croghan Community Centre, Croghan, Co. Offaly, 30/03/2023
- Pre-Application Meeting with An Bord Pleanála, 12/05/2023
- Meeting with Offaly County Council official, 19/06/2023
- Pre-Application Meeting with the Environmental Protection Agency, 07/07/2023

Appendix F – Schedule of Prescribed Bodies (Sample Letter overleaf and all letters to Prescribed Bodies)

Appendix F - Schedule of Prescribed Bodies (Sample Letter overleaf)

1. Department of the Environment, Climate and Communications.
2. Department of Housing, Local Government and Heritage.
3. Offaly County Council
4. Westmeath County Council
5. Eastern and Midland Regional Assembly
6. EirGrid
7. Transport Infrastructure Ireland
8. Inland Fisheries Ireland
9. Irish Water.
10. Commission for Regulation of Utilities.
11. An Taisce.
12. An Chomhairle Ealaíon.
13. Fáilte Ireland.
14. The Heritage Council
15. Health and Safety Authority

06 February 2024

Department of Housing, Local Government and Heritage,
Custom House,
Dublin
D01 W6X0

Dear Sir/Madam,

Proposal: Strategic Infrastructure Development - Proposed Combined Cycle Gas Turbine (570MW) and an Open Cycle Gas Turbine (140MW) Thermal Power Plant and electricity grid connection including 2 no substations and associated buildings, plant, site works services and ancillary development on land within the townlands of Knockdrin, Derrygreenagh, Derryarkin, Derryiron, Ballybeg, Coolcor, Barrysbrook, Clonin, Togher and Coole, Co. Offaly.

On behalf of the applicant, Bord na Móna Powergen Limited¹, we hereby submit a planning application for Strategic Infrastructure Development ('SID') for a Combined Cycle Gas Turbine ('CCGT') and Open Cycle Gas Turbine ('OCGT') Thermal Power Plant, Electricity Grid Connection including 2 no. substations, and associated buildings, plant, site works, services and ancillary development on land within the townlands of Knockdrin, Derrygreenagh, Derryarkin, Derryiron, Ballybeg, Coolcor, Barrysbrook, Clonin, Togher and Coole, Co. Offaly.

The development description reads as follows:

10-year planning permission to develop a Combined Cycle Gas Turbine ('CCGT') and Open Cycle Gas Turbine ('OCGT') Thermal Power Plant, Electricity Grid Connection including 2 no. substations, and associated buildings, plant, site works, services and ancillary development on land within the townlands of Knockdrin, Derrygreenagh, Derryarkin, Derryiron, Ballybeg, Coolcor, Barrysbrook, Clonin, Togher and Coole, Co. Offaly.

The Proposed Development will encompass a Power Plant Area and an Electricity Grid Connection.

The development of the Power Plant Area will include the following:

¹ c/o Bord na Mona, Main Street, Newbridge, Co Kildare

- *Demolition of existing buildings at the Derrygreenagh Works site (Including office building, boiler house, workshops, water tank and storage unit);*
- *Construction of CCGT power plant (570MW) [Including turbine hall and associated buildings, air cooled condensers ('ACC'), Heat Recovery Steam Generator ('HRSG'), air intake, emissions stack (60m high) with Continuous Emissions Monitoring System ('CEMS') and platform];*
- *Ancillary coolers;*
- *Fuel gas performance heating room*
- *Generator transformer and unit auxiliary transformer;*
- *OCGT power plant (140MW) [Including turbine enclosures, air intakes, fin fan coolers, emissions stack (45m high), electrical rooms, main transformer];*
- *Secondary fuel storage tanks and unloading area [Including unloading layby, 2 no. fuel storage tanks, fuel pumping and cleaning plant, fuel forwarding building];*
- *2 no. water abstraction boreholes;*
- *Raw water storage tank;*
- *2 no. demineralised water storage tanks;*
- *Water treatment plant;*
- *Administration building and staff car park;*
- *Wastewater treatment plant;*
- *Workshop and stores building;*
- *Process water treatment plant;*
- *Gas Above Ground Installation ('AGI') compound [Including regulator building, instrumentation kiosks, palisade fencing];*
- *Gas receiving facility [Including gas compressor building, fin fan coolers, pressure reducing station];*
- *Drainage infrastructure [Including surface water attenuation tank, surface water discharge pipeline (Discharging to the Mongagh River), treated process and wastewater discharge pipeline (Discharging to the Yellow River)];*
- *A new site access from the R400 road;*
- *All internal access roads;*
- *Security fencing and gates;*
- *Landscaping*
- *Site works and services*
- *All ancillary infrastructure and plant [Including firefighting systems, fire water pumphouse, raw water pumphouse, emergency diesel generator, propane stores, chemical storage tanks and pumphouse, lube oil storage building, silencers, vents, drains, safety valves, lighting, and pipe gantries];*
- *A permanent Peat and Spoil Deposition Area ('PDA') of approx. 225,000 sq. m. will be located to the south-east of the Power Plant Area.*

The development of the Electricity Grid Connection will include the following:

- *A 220kV substation located to the west of the Power Plant Area and R400 road [Hybrid gas insulated switchgear ('GIS')/air insulated switchgear ('AIS') substation design including switchgear building; control room building; transformer bays; 2. no. lattice gantries (c. 20m high) to support overhead line connection; telecommunications mast (c. 36m high); security fencing; landscaping, new access on to R400 road];*

- 220kV overhead line running for c. 5km to the south of the 220kV substation, facilitated by double circuit suspension pylon towers (13 no.; c. 44m high) and strain pylon towers (6 no.; c. 38m high);
- 220kV line-cable interface compound [Including interface tower gantry (c. 20m high); cable sealing ends; security fencing];
- 220kV underground cable connection running for c. 3.4km to the south [With paved and gated service road and 12 no. joint bays to facilitate construction and servicing];
- A 400kV GIS substation located adjacent to the existing Oldstreet-Woodland 400kV overhead line [Including a 400kV GIS building; 220kV GIS building; transformer compound; 2 no. lattice gantries (c. 28m high) to support overhead line connection to 2 no. new loop-in strain towers (c. 32.5m high) on the Oldstreet-Woodland 400kV line; telecommunications mast (c. 36m high); security fencing; landscaping, access off L1010 road];
- 2 no. permanent Peat Deposition Areas will be provided as part of the Electricity Grid Connection – one to the north of the 400kV substation (c. 75,300 sq. m) and one to the south-west of the 220kV substation (c. 50,200 sq. m.);
- Tree Replanting Areas (c. 17.5 ha.) are proposed within the planning boundary to compensate for all tree felling requirements associated with the Proposed Development.

The application relates to development for the purposes of an activity requiring a license from the Environmental Protection Agency under the Industrial Emissions Directive. It also relates to a Lower Tier COMAH establishment and therefore falls under the requirements of the Control of Major Accident Hazard (COMAH) Regulations, 2015.

An Environmental Impact Assessment Report ('EIAR') and Natura Impact Statement ('NIS') will be submitted with the application.

The Proposed Development provides flexible, dispatchable electricity generation capacity which will help to maintain security of electricity supply into the future, while supporting Ireland in its transition to a low carbon economy in line with National Development Plan and Climate Action Plan objectives. It will help to replace generation capacity that will be lost through the planned retirement of older, more carbon-intensive power stations in the coming years and will facilitate a sustainable transition to renewable fuels such as hydrogen, in line with national commitments for blending renewable fuels into the gas network.

The application is being made directly to An Bord Pleanála² as 'Strategic Infrastructure Development' (SID) under the provisions of Section 37E the Planning and Development Act 2000 (as amended). An Bord Pleanála has required that we notify the Department of Housing, Local Government and Heritage of the submission of the application.

All documentation for this planning application can be found at www.derrygreenaghpowerplanning.ie, including:

- ABP SID Planning Application Form and Appendices
- Cover Letter and Appendices
- Planning Statement

² An Bord Pleanála, 64 Marlborough Street, Dublin 1

- Drainage Engineering Assessment Report
- Environmental Impact Assessment Report (EIAR)³
- Application Drawings

You are advised that the Board may, in respect of an application for permission, decide to:

- (a) (i) grant the permission/approval,
or
- (ii) make such modifications to the proposed development as it specifies in its decision and grant permission/approval in respect of the proposed development as so modified,
or
- (iii) grant permission/approval in respect of part of the proposed development (with or without specified modifications of the foregoing kind), and any of the above decisions may be subject to or without conditions,
or
- (b) Refuse to grant the permission/approval.

Submissions or Observations may be made only to An Bord Pleanála, 64 Marlborough Street, Dublin 1 relating to:

- i. The implications of the proposed development for proper planning and sustainable development, and
- ii. The likely effects on the environment of the proposed development, and
- iii. The likely significant effects of the proposed development on a European site, if carried out.

Any submissions/observations must be received by the Board no later than 5.30 p.m. on 5th April 2024.

Yours sincerely,



Sean Breslin

Senior Consultant, Planning

³ Includes Natura Impact Statement and COMAH Land Use Planning Risk Assessment

07 February 2024

An Chomhairle Ealaoin,
The Arts Council,
70 Merrion Square
Dublin
D02 NY52

Dear Sir/Madam,

Proposal: Strategic Infrastructure Development - Proposed Combined Cycle Gas Turbine (570MW) and an Open Cycle Gas Turbine (140MW) Thermal Power Plant and electricity grid connection including 2 no substations and associated buildings, plant, site works services and ancillary development on land within the townlands of Knockdrin, Derrygreenagh, Derryarkin, Derryiron, Ballybeg, Coolcor, Barrysbrook, Clonin, Togher and Coole, Co. Offaly.

On behalf of the applicant, Bord na Móna Powergen Limited¹, we hereby submit a planning application for Strategic Infrastructure Development ('SID') for a Combined Cycle Gas Turbine ('CCGT') and Open Cycle Gas Turbine ('OCGT') Thermal Power Plant, Electricity Grid Connection including 2 no. substations, and associated buildings, plant, site works, services and ancillary development on land within the townlands of Knockdrin, Derrygreenagh, Derryarkin, Derryiron, Ballybeg, Coolcor, Barrysbrook, Clonin, Togher and Coole, Co. Offaly.

The development description reads as follows:

10-year planning permission to develop a Combined Cycle Gas Turbine ('CCGT') and Open Cycle Gas Turbine ('OCGT') Thermal Power Plant, Electricity Grid Connection including 2 no. substations, and associated buildings, plant, site works, services and ancillary development on land within the townlands of Knockdrin, Derrygreenagh, Derryarkin, Derryiron, Ballybeg, Coolcor, Barrysbrook, Clonin, Togher and Coole, Co. Offaly.

The Proposed Development will encompass a Power Plant Area and an Electricity Grid Connection.

The development of the Power Plant Area will include the following:

¹ c/o Bord na Mona, Main Street, Newbridge, Co Kildare

- *Demolition of existing buildings at the Derrygreenagh Works site (Including office building, boiler house, workshops, water tank and storage unit);*
- *Construction of CCGT power plant (570MW) [Including turbine hall and associated buildings, air cooled condensers ('ACC'), Heat Recovery Steam Generator ('HRSG'), air intake, emissions stack (60m high) with Continuous Emissions Monitoring System ('CEMS') and platform];*
- *Ancillary coolers;*
- *Fuel gas performance heating room*
- *Generator transformer and unit auxiliary transformer;*
- *OCGT power plant (140MW) [Including turbine enclosures, air intakes, fin fan coolers, emissions stack (45m high), electrical rooms, main transformer];*
- *Secondary fuel storage tanks and unloading area [Including unloading layby, 2 no. fuel storage tanks, fuel pumping and cleaning plant, fuel forwarding building];*
- *2 no. water abstraction boreholes;*
- *Raw water storage tank;*
- *2 no. demineralised water storage tanks;*
- *Water treatment plant;*
- *Administration building and staff car park;*
- *Wastewater treatment plant;*
- *Workshop and stores building;*
- *Process water treatment plant;*
- *Gas Above Ground Installation ('AGI') compound [Including regulator building, instrumentation kiosks, palisade fencing];*
- *Gas receiving facility [Including gas compressor building, fin fan coolers, pressure reducing station];*
- *Drainage infrastructure [Including surface water attenuation tank, surface water discharge pipeline (Discharging to the Mongagh River), treated process and wastewater discharge pipeline (Discharging to the Yellow River)];*
- *A new site access from the R400 road;*
- *All internal access roads;*
- *Security fencing and gates;*
- *Landscaping*
- *Site works and services*
- *All ancillary infrastructure and plant [Including firefighting systems, fire water pumphouse, raw water pumphouse, emergency diesel generator, propane stores, chemical storage tanks and pumphouse, lube oil storage building, silencers, vents, drains, safety valves, lighting, and pipe gantries];*
- *A permanent Peat and Spoil Deposition Area ('PDA') of approx. 225,000 sq. m. will be located to the south-east of the Power Plant Area.*

The development of the Electricity Grid Connection will include the following:

- *A 220kV substation located to the west of the Power Plant Area and R400 road [Hybrid gas insulated switchgear ('GIS')/air insulated switchgear ('AIS') substation design including switchgear building; control room building; transformer bays; 2. no. lattice gantries (c. 20m high) to support overhead line connection; telecommunications mast (c. 36m high); security fencing; landscaping, new access on to R400 road];*

- 220kV overhead line running for c. 5km to the south of the 220kV substation, facilitated by double circuit suspension pylon towers (13 no.; c. 44m high) and strain pylon towers (6 no.; c. 38m high);
- 220kV line-cable interface compound [Including interface tower gantry (c. 20m high); cable sealing ends; security fencing];
- 220kV underground cable connection running for c. 3.4km to the south [With paved and gated service road and 12 no. joint bays to facilitate construction and servicing];
- A 400kV GIS substation located adjacent to the existing Oldstreet-Woodland 400kV overhead line [Including a 400kV GIS building; 220kV GIS building; transformer compound; 2 no. lattice gantries (c. 28m high) to support overhead line connection to 2 no. new loop-in strain towers (c. 32.5m high) on the Oldstreet-Woodland 400kV line; telecommunications mast (c. 36m high); security fencing; landscaping, access off L1010 road];
- 2 no. permanent Peat Deposition Areas will be provided as part of the Electricity Grid Connection – one to the north of the 400kV substation (c. 75,300 sq. m) and one to the south-west of the 220kV substation (c. 50,200 sq. m.);
- Tree Replanting Areas (c. 17.5 ha.) are proposed within the planning boundary to compensate for all tree felling requirements associated with the Proposed Development.

The application relates to development for the purposes of an activity requiring a license from the Environmental Protection Agency under the Industrial Emissions Directive. It also relates to a Lower Tier COMAH establishment and therefore falls under the requirements of the Control of Major Accident Hazard (COMAH) Regulations, 2015.

An Environmental Impact Assessment Report ('EIAR') and Natura Impact Statement ('NIS') will be submitted with the application.

The Proposed Development provides flexible, dispatchable electricity generation capacity which will help to maintain security of electricity supply into the future, while supporting Ireland in its transition to a low carbon economy in line with National Development Plan and Climate Action Plan objectives. It will help to replace generation capacity that will be lost through the planned retirement of older, more carbon-intensive power stations in the coming years and will facilitate a sustainable transition to renewable fuels such as hydrogen, in line with national commitments for blending renewable fuels into the gas network.

The application is being made directly to An Bord Pleanála² as 'Strategic Infrastructure Development' (SID) under the provisions of Section 37E the Planning and Development Act 2000 (as amended). An Bord Pleanála has required that we notify An Chomhairle Ealaíon of the submission of the application.

All documentation for this planning application can be found at www.derrygreenaghpowerplanning.ie, including:

- ABP SID Planning Application Form and Appendices
- Cover Letter and Appendices
- Planning Statement

² An Bord Pleanála, 64 Marlborough Street, Dublin 1

- Drainage Engineering Assessment Report
- Environmental Impact Assessment Report (EIAR)³
- Application Drawings

You are advised that the Board may, in respect of an application for permission, decide to:

- (a) (i) grant the permission/approval,
or
- (ii) make such modifications to the proposed development as it specifies in its decision and grant permission/approval in respect of the proposed development as so modified,
or
- (iii) grant permission/approval in respect of part of the proposed development (with or without specified modifications of the foregoing kind), and any of the above decisions may be subject to or without conditions,
or
- (b) Refuse to grant the permission/approval.

Submissions or Observations may be made only to An Bord Pleanála, 64 Marlborough Street, Dublin 1 relating to:

- i. The implications of the proposed development for proper planning and sustainable development, and
- ii. The likely effects on the environment of the proposed development, and
- iii. The likely significant effects of the proposed development on a European site, if carried out.

Any submissions/observations must be received by the Board no later than 5.30 p.m. on 5th April 2024.

Yours sincerely,



Sean Breslin

Senior Consultant, Planning

³ Includes Natura Impact Statement and COMAH Land Use Planning Risk Assessment

07 February 2024

An Taisce
Tailor's Lane
Back Lane
Dublin
D08 X2A3

Dear Sir/Madam,

Proposal: Strategic Infrastructure Development - Proposed Combined Cycle Gas Turbine (570MW) and an Open Cycle Gas Turbine (140MW) Thermal Power Plant and electricity grid connection including 2 no substations and associated buildings, plant, site works services and ancillary development on land within the townlands of Knockdrin, Derrygreenagh, Derryarkin, Derryiron, Ballybeg, Coolcor, Barrysbrook, Clonin, Togher and Coole, Co. Offaly.

On behalf of the applicant, Bord na Móna Powergen Limited¹, we hereby submit a planning application for Strategic Infrastructure Development ('SID') for a Combined Cycle Gas Turbine ('CCGT') and Open Cycle Gas Turbine ('OCGT') Thermal Power Plant, Electricity Grid Connection including 2 no. substations, and associated buildings, plant, site works, services and ancillary development on land within the townlands of Knockdrin, Derrygreenagh, Derryarkin, Derryiron, Ballybeg, Coolcor, Barrysbrook, Clonin, Togher and Coole, Co. Offaly.

The development description reads as follows:

10-year planning permission to develop a Combined Cycle Gas Turbine ('CCGT') and Open Cycle Gas Turbine ('OCGT') Thermal Power Plant, Electricity Grid Connection including 2 no. substations, and associated buildings, plant, site works, services and ancillary development on land within the townlands of Knockdrin, Derrygreenagh, Derryarkin, Derryiron, Ballybeg, Coolcor, Barrysbrook, Clonin, Togher and Coole, Co. Offaly.

The Proposed Development will encompass a Power Plant Area and an Electricity Grid Connection.

The development of the Power Plant Area will include the following:

¹ c/o Bord na Mona, Main Street, Newbridge, Co Kildare

- Demolition of existing buildings at the Derrygreenagh Works site (Including office building, boiler house, workshops, water tank and storage unit);
- Construction of CCGT power plant (570MW) [Including turbine hall and associated buildings, air cooled condensers ('ACC'), Heat Recovery Steam Generator ('HRSG'), air intake, emissions stack (60m high) with Continuous Emissions Monitoring System ('CEMS') and platform];
- Ancillary coolers;
- Fuel gas performance heating room
- Generator transformer and unit auxiliary transformer;
- OCGT power plant (140MW) [Including turbine enclosures, air intakes, fin fan coolers, emissions stack (45m high), electrical rooms, main transformer];
- Secondary fuel storage tanks and unloading area [Including unloading layby, 2 no. fuel storage tanks, fuel pumping and cleaning plant, fuel forwarding building];
- 2 no. water abstraction boreholes;
- Raw water storage tank;
- 2 no. demineralised water storage tanks;
- Water treatment plant;
- Administration building and staff car park;
- Wastewater treatment plant;
- Workshop and stores building;
- Process water treatment plant;
- Gas Above Ground Installation ('AGI') compound [Including regulator building, instrumentation kiosks, palisade fencing];
- Gas receiving facility [Including gas compressor building, fin fan coolers, pressure reducing station];
- Drainage infrastructure [Including surface water attenuation tank, surface water discharge pipeline (Discharging to the Mongagh River), treated process and wastewater discharge pipeline (Discharging to the Yellow River)];
- A new site access from the R400 road;
- All internal access roads;
- Security fencing and gates;
- Landscaping
- Site works and services
- All ancillary infrastructure and plant [Including firefighting systems, fire water pumphouse, raw water pumphouse, emergency diesel generator, propane stores, chemical storage tanks and pumphouse, lube oil storage building, silencers, vents, drains, safety valves, lighting, and pipe gantries];
- A permanent Peat and Spoil Deposition Area ('PDA') of approx. 225,000 sq. m. will be located to the south-east of the Power Plant Area.

The development of the Electricity Grid Connection will include the following:

- A 220kV substation located to the west of the Power Plant Area and R400 road [Hybrid gas insulated switchgear ('GIS')/air insulated switchgear ('AIS') substation design including switchgear building; control room building; transformer bays; 2. no. lattice gantries (c. 20m high) to support overhead line connection; telecommunications mast (c. 36m high); security fencing; landscaping, new access on to R400 road];

- 220kV overhead line running for c. 5km to the south of the 220kV substation, facilitated by double circuit suspension pylon towers (13 no.; c. 44m high) and strain pylon towers (6 no.; c. 38m high);
- 220kV line-cable interface compound [Including interface tower gantry (c. 20m high); cable sealing ends; security fencing];
- 220kV underground cable connection running for c. 3.4km to the south [With paved and gated service road and 12 no. joint bays to facilitate construction and servicing];
- A 400kV GIS substation located adjacent to the existing Oldstreet-Woodland 400kV overhead line [Including a 400kV GIS building; 220kV GIS building; transformer compound; 2 no. lattice gantries (c. 28m high) to support overhead line connection to 2 no. new loop-in strain towers (c. 32.5m high) on the Oldstreet-Woodland 400kV line; telecommunications mast (c. 36m high); security fencing; landscaping, access off L1010 road];
- 2 no. permanent Peat Deposition Areas will be provided as part of the Electricity Grid Connection – one to the north of the 400kV substation (c. 75,300 sq. m) and one to the south-west of the 220kV substation (c. 50,200 sq. m.);
- Tree Replanting Areas (c. 17.5 ha.) are proposed within the planning boundary to compensate for all tree felling requirements associated with the Proposed Development.

The application relates to development for the purposes of an activity requiring a license from the Environmental Protection Agency under the Industrial Emissions Directive. It also relates to a Lower Tier COMAH establishment and therefore falls under the requirements of the Control of Major Accident Hazard (COMAH) Regulations, 2015.

An Environmental Impact Assessment Report ('EIAR') and Natura Impact Statement ('NIS') will be submitted with the application.

The Proposed Development provides flexible, dispatchable electricity generation capacity which will help to maintain security of electricity supply into the future, while supporting Ireland in its transition to a low carbon economy in line with National Development Plan and Climate Action Plan objectives. It will help to replace generation capacity that will be lost through the planned retirement of older, more carbon-intensive power stations in the coming years and will facilitate a sustainable transition to renewable fuels such as hydrogen, in line with national commitments for blending renewable fuels into the gas network.

The application is being made directly to An Bord Pleanála² as 'Strategic Infrastructure Development' (SID) under the provisions of Section 37E the Planning and Development Act 2000 (as amended). An Bord Pleanála has required that we notify An Taisce of the submission of the application.

All documentation for this planning application can be found at www.derrygreenaghpowerplanning.ie, including:

- ABP SID Planning Application Form and Appendices
- Cover Letter and Appendices
- Planning Statement

² An Bord Pleanála, 64 Marlborough Street, Dublin 1

- Drainage Engineering Assessment Report
- Environmental Impact Assessment Report (EIAR)³
- Application Drawings

You are advised that the Board may, in respect of an application for permission, decide to:

- (a) (i) grant the permission/approval,
or
- (ii) make such modifications to the proposed development as it specifies in its decision and grant permission/approval in respect of the proposed development as so modified,
or
- (iii) grant permission/approval in respect of part of the proposed development (with or without specified modifications of the foregoing kind), and any of the above decisions may be subject to or without conditions,
or
- (b) Refuse to grant the permission/approval.

Submissions or Observations may be made only to An Bord Pleanála, 64 Marlborough Street, Dublin 1 relating to:

- i. The implications of the proposed development for proper planning and sustainable development, and
- ii. The likely effects on the environment of the proposed development, and
- iii. The likely significant effects of the proposed development on a European site, if carried out.

Any submissions/observations must be received by the Board no later than 5.30 p.m. on 5th April 2024.

Yours sincerely,



Sean Breslin

Senior Consultant, Planning

³ Includes Natura Impact Statement and COMAH Land Use Planning Risk Assessment

07 February 2024

Commission for Regulation of Utilities,
CRU Customer Care Team,
P.O. Box 11934,
Dublin 24

Dear Sir/Madam,

Proposal: Strategic Infrastructure Development - Proposed Combined Cycle Gas Turbine (570MW) and an Open Cycle Gas Turbine (140MW) Thermal Power Plant and electricity grid connection including 2 no substations and associated buildings, plant, site works services and ancillary development on land within the townlands of Knockdrin, Derrygreenagh, Derryarkin, Derryiron, Ballybeg, Coolcor, Barrysbrook, Clonin, Togher and Coole, Co. Offaly.

On behalf of the applicant, Bord na Móna Powergen Limited¹, we hereby submit a planning application for Strategic Infrastructure Development ('SID') for a Combined Cycle Gas Turbine ('CCGT') and Open Cycle Gas Turbine ('OCGT') Thermal Power Plant, Electricity Grid Connection including 2 no. substations, and associated buildings, plant, site works, services and ancillary development on land within the townlands of Knockdrin, Derrygreenagh, Derryarkin, Derryiron, Ballybeg, Coolcor, Barrysbrook, Clonin, Togher and Coole, Co. Offaly.

The development description reads as follows:

10-year planning permission to develop a Combined Cycle Gas Turbine ('CCGT') and Open Cycle Gas Turbine ('OCGT') Thermal Power Plant, Electricity Grid Connection including 2 no. substations, and associated buildings, plant, site works, services and ancillary development on land within the townlands of Knockdrin, Derrygreenagh, Derryarkin, Derryiron, Ballybeg, Coolcor, Barrysbrook, Clonin, Togher and Coole, Co. Offaly.

The Proposed Development will encompass a Power Plant Area and an Electricity Grid Connection.

The development of the Power Plant Area will include the following:

¹ c/o Bord na Mona, Main Street, Newbridge, Co Kildare

- *Demolition of existing buildings at the Derrygreenagh Works site (Including office building, boiler house, workshops, water tank and storage unit);*
- *Construction of CCGT power plant (570MW) [Including turbine hall and associated buildings, air cooled condensers ('ACC'), Heat Recovery Steam Generator ('HRSG'), air intake, emissions stack (60m high) with Continuous Emissions Monitoring System ('CEMS') and platform];*
- *Ancillary coolers;*
- *Fuel gas performance heating room*
- *Generator transformer and unit auxiliary transformer;*
- *OCGT power plant (140MW) [Including turbine enclosures, air intakes, fin fan coolers, emissions stack (45m high), electrical rooms, main transformer];*
- *Secondary fuel storage tanks and unloading area [Including unloading layby, 2 no. fuel storage tanks, fuel pumping and cleaning plant, fuel forwarding building];*
- *2 no. water abstraction boreholes;*
- *Raw water storage tank;*
- *2 no. demineralised water storage tanks;*
- *Water treatment plant;*
- *Administration building and staff car park;*
- *Wastewater treatment plant;*
- *Workshop and stores building;*
- *Process water treatment plant;*
- *Gas Above Ground Installation ('AGI') compound [Including regulator building, instrumentation kiosks, palisade fencing];*
- *Gas receiving facility [Including gas compressor building, fin fan coolers, pressure reducing station];*
- *Drainage infrastructure [Including surface water attenuation tank, surface water discharge pipeline (Discharging to the Mongagh River), treated process and wastewater discharge pipeline (Discharging to the Yellow River)];*
- *A new site access from the R400 road;*
- *All internal access roads;*
- *Security fencing and gates;*
- *Landscaping*
- *Site works and services*
- *All ancillary infrastructure and plant [Including firefighting systems, fire water pumphouse, raw water pumphouse, emergency diesel generator, propane stores, chemical storage tanks and pumphouse, lube oil storage building, silencers, vents, drains, safety valves, lighting, and pipe gantries];*
- *A permanent Peat and Spoil Deposition Area ('PDA') of approx. 225,000 sq. m. will be located to the south-east of the Power Plant Area.*

The development of the Electricity Grid Connection will include the following:

- *A 220kV substation located to the west of the Power Plant Area and R400 road [Hybrid gas insulated switchgear ('GIS')/air insulated switchgear ('AIS') substation design including switchgear building; control room building; transformer bays; 2. no. lattice gantries (c. 20m high) to support overhead line connection; telecommunications mast (c. 36m high); security fencing; landscaping, new access on to R400 road];*

- 220kV overhead line running for c. 5km to the south of the 220kV substation, facilitated by double circuit suspension pylon towers (13 no.; c. 44m high) and strain pylon towers (6 no.; c. 38m high);
- 220kV line-cable interface compound [Including interface tower gantry (c. 20m high); cable sealing ends; security fencing];
- 220kV underground cable connection running for c. 3.4km to the south [With paved and gated service road and 12 no. joint bays to facilitate construction and servicing];
- A 400kV GIS substation located adjacent to the existing Oldstreet-Woodland 400kV overhead line [Including a 400kV GIS building; 220kV GIS building; transformer compound; 2 no. lattice gantries (c. 28m high) to support overhead line connection to 2 no. new loop-in strain towers (c. 32.5m high) on the Oldstreet-Woodland 400kV line; telecommunications mast (c. 36m high); security fencing; landscaping, access off L1010 road];
- 2 no. permanent Peat Deposition Areas will be provided as part of the Electricity Grid Connection – one to the north of the 400kV substation (c. 75,300 sq. m) and one to the south-west of the 220kV substation (c. 50,200 sq. m.);
- Tree Replanting Areas (c. 17.5 ha.) are proposed within the planning boundary to compensate for all tree felling requirements associated with the Proposed Development.

The application relates to development for the purposes of an activity requiring a license from the Environmental Protection Agency under the Industrial Emissions Directive. It also relates to a Lower Tier COMAH establishment and therefore falls under the requirements of the Control of Major Accident Hazard (COMAH) Regulations, 2015.

An Environmental Impact Assessment Report ('EIAR') and Natura Impact Statement ('NIS') will be submitted with the application.

The Proposed Development provides flexible, dispatchable electricity generation capacity which will help to maintain security of electricity supply into the future, while supporting Ireland in its transition to a low carbon economy in line with National Development Plan and Climate Action Plan objectives. It will help to replace generation capacity that will be lost through the planned retirement of older, more carbon-intensive power stations in the coming years and will facilitate a sustainable transition to renewable fuels such as hydrogen, in line with national commitments for blending renewable fuels into the gas network.

The application is being made directly to An Bord Pleanála² as 'Strategic Infrastructure Development' (SID) under the provisions of Section 37E the Planning and Development Act 2000 (as amended). An Bord Pleanála has required that we notify the Commission for Regulation of Utilities of the submission of the application.

All documentation for this planning application can be found at www.derrygreenaghpowerplanning.ie, including:

- ABP SID Planning Application Form and Appendices
- Cover Letter and Appendices
- Planning Statement

² An Bord Pleanála, 64 Marlborough Street, Dublin 1

- Drainage Engineering Assessment Report
- Environmental Impact Assessment Report (EIAR)³
- Application Drawings

You are advised that the Board may, in respect of an application for permission, decide to:

- (a) (i) grant the permission/approval,
or
- (ii) make such modifications to the proposed development as it specifies in its decision and grant permission/approval in respect of the proposed development as so modified,
or
- (iii) grant permission/approval in respect of part of the proposed development (with or without specified modifications of the foregoing kind), and any of the above decisions may be subject to or without conditions,
or
- (b) Refuse to grant the permission/approval.

Submissions or Observations may be made only to An Bord Pleanála, 64 Marlborough Street, Dublin 1 relating to:

- i. The implications of the proposed development for proper planning and sustainable development, and
- ii. The likely effects on the environment of the proposed development, and
- iii. The likely significant effects of the proposed development on a European site, if carried out.

Any submissions/observations must be received by the Board no later than 5.30 p.m. on 5th April 2024.

Yours sincerely,



Sean Breslin

Senior Consultant, Planning

³ Includes Natura Impact Statement and COMAH Land Use Planning Risk Assessment

07 February 2024

EirGrid,
The Oval,
160 Shelbourne Road,
Ballsbridge,
Dublin,
D04 FW28

Dear Sir/Madam,

Proposal: Strategic Infrastructure Development - Proposed Combined Cycle Gas Turbine (570MW) and an Open Cycle Gas Turbine (140MW) Thermal Power Plant and electricity grid connection including 2 no substations and associated buildings, plant, site works services and ancillary development on land within the townlands of Knockdrin, Derrygreenagh, Derryarkin, Derryiron, Ballybeg, Coolcor, Barrysbrook, Clonin, Togher and Coole, Co. Offaly.

On behalf of the applicant, Bord na Móna Powergen Limited¹, we hereby submit a planning application for Strategic Infrastructure Development ('SID') for a Combined Cycle Gas Turbine ('CCGT') and Open Cycle Gas Turbine ('OCGT') Thermal Power Plant, Electricity Grid Connection including 2 no. substations, and associated buildings, plant, site works, services and ancillary development on land within the townlands of Knockdrin, Derrygreenagh, Derryarkin, Derryiron, Ballybeg, Coolcor, Barrysbrook, Clonin, Togher and Coole, Co. Offaly.

The development description reads as follows:

10-year planning permission to develop a Combined Cycle Gas Turbine ('CCGT') and Open Cycle Gas Turbine ('OCGT') Thermal Power Plant, Electricity Grid Connection including 2 no. substations, and associated buildings, plant, site works, services and ancillary development on land within the townlands of Knockdrin, Derrygreenagh, Derryarkin, Derryiron, Ballybeg, Coolcor, Barrysbrook, Clonin, Togher and Coole, Co. Offaly.

The Proposed Development will encompass a Power Plant Area and an Electricity Grid Connection.

¹ c/o Bord na Mona, Main Street, Newbridge, Co Kildare

The development of the Power Plant Area will include the following:

- *Demolition of existing buildings at the Derrygreenagh Works site (Including office building, boiler house, workshops, water tank and storage unit);*
- *Construction of CCGT power plant (570MW) [Including turbine hall and associated buildings, air cooled condensers ('ACC'), Heat Recovery Steam Generator ('HRSG'), air intake, emissions stack (60m high) with Continuous Emissions Monitoring System ('CEMS') and platform];*
- *Ancillary coolers;*
- *Fuel gas performance heating room*
- *Generator transformer and unit auxiliary transformer;*
- *OCGT power plant (140MW) [Including turbine enclosures, air intakes, fin fan coolers, emissions stack (45m high), electrical rooms, main transformer];*
- *Secondary fuel storage tanks and unloading area [Including unloading layby, 2 no. fuel storage tanks, fuel pumping and cleaning plant, fuel forwarding building];*
- *2 no. water abstraction boreholes;*
- *Raw water storage tank;*
- *2 no. demineralised water storage tanks;*
- *Water treatment plant;*
- *Administration building and staff car park;*
- *Wastewater treatment plant;*
- *Workshop and stores building;*
- *Process water treatment plant;*
- *Gas Above Ground Installation ('AGI') compound [Including regulator building, instrumentation kiosks, palisade fencing];*
- *Gas receiving facility [Including gas compressor building, fin fan coolers, pressure reducing station];*
- *Drainage infrastructure [Including surface water attenuation tank, surface water discharge pipeline (Discharging to the Mongagh River), treated process and wastewater discharge pipeline (Discharging to the Yellow River)];*
- *A new site access from the R400 road;*
- *All internal access roads;*
- *Security fencing and gates;*
- *Landscaping*
- *Site works and services*
- *All ancillary infrastructure and plant [Including firefighting systems, fire water pumphouse, raw water pumphouse, emergency diesel generator, propane stores, chemical storage tanks and pumphouse, lube oil storage building, silencers, vents, drains, safety valves, lighting, and pipe gantries];*
- *A permanent Peat and Spoil Deposition Area ('PDA') of approx. 225,000 sq. m. will be located to the south-east of the Power Plant Area.*

The development of the Electricity Grid Connection will include the following:

- *A 220kV substation located to the west of the Power Plant Area and R400 road [Hybrid gas insulated switchgear ('GIS')/air insulated switchgear ('AIS') substation design including switchgear building; control room building; transformer bays; 2. no. lattice gantries (c. 20m*

high) to support overhead line connection; telecommunications mast (c. 36m high); security fencing; landscaping, new access on to R400 road];

- *220kV overhead line running for c. 5km to the south of the 220kV substation, facilitated by double circuit suspension pylon towers (13 no.; c. 44m high) and strain pylon towers (6 no.; c. 38m high);*
- *220kV line-cable interface compound [Including interface tower gantry (c. 20m high); cable sealing ends; security fencing];*
- *220kV underground cable connection running for c. 3.4km to the south [With paved and gated service road and 12 no. joint bays to facilitate construction and servicing];*
- *A 400kV GIS substation located adjacent to the existing Oldstreet-Woodland 400kV overhead line [Including a 400kV GIS building; 220kV GIS building; transformer compound; 2 no. lattice gantries (c. 28m high) to support overhead line connection to 2 no. new loop-in strain towers (c. 32.5m high) on the Oldstreet-Woodland 400kV line; telecommunications mast (c. 36m high); security fencing; landscaping, access off L1010 road];*
- *2 no. permanent Peat Deposition Areas will be provided as part of the Electricity Grid Connection – one to the north of the 400kV substation (c. 75,300 sq. m) and one to the south-west of the 220kV substation (c. 50,200 sq. m.);*
- *Tree Replanting Areas (c. 17.5 ha.) are proposed within the planning boundary to compensate for all tree felling requirements associated with the Proposed Development.*

The application relates to development for the purposes of an activity requiring a license from the Environmental Protection Agency under the Industrial Emissions Directive. It also relates to a Lower Tier COMAH establishment and therefore falls under the requirements of the Control of Major Accident Hazard (COMAH) Regulations, 2015.

An Environmental Impact Assessment Report ('EIAR') and Natura Impact Statement ('NIS') will be submitted with the application.

The Proposed Development provides flexible, dispatchable electricity generation capacity which will help to maintain security of electricity supply into the future, while supporting Ireland in its transition to a low carbon economy in line with National Development Plan and Climate Action Plan objectives. It will help to replace generation capacity that will be lost through the planned retirement of older, more carbon-intensive power stations in the coming years and will facilitate a sustainable transition to renewable fuels such as hydrogen, in line with national commitments for blending renewable fuels into the gas network.

The application is being made directly to An Bord Pleanála² as 'Strategic Infrastructure Development'(SID) under the provisions of Section 37E the Planning and Development Act 2000 (as amended). An Bord Pleanála has required that we notify EirGrid of the submission of the application.

All documentation for this planning application can be found at www.derrygreenaghpowerplanning.ie , including:

- ABP SID Planning Application Form and Appendices
- Cover Letter and Appendices

² An Bord Pleanála, 64 Marlborough Street, Dublin 1

- Planning Statement
- Drainage Engineering Assessment Report
- Environmental Impact Assessment Report (EIAR)³
- Application Drawings

You are advised that the Board may, in respect of an application for permission, decide to:

- (a) (i) grant the permission/approval,
or
- (ii) make such modifications to the proposed development as it specifies in its decision and grant permission/approval in respect of the proposed development as so modified,
or
- (iii) grant permission/approval in respect of part of the proposed development (with or without specified modifications of the foregoing kind), and any of the above decisions may be subject to or without conditions,
or
- (b) Refuse to grant the permission/approval.

Submissions or Observations may be made only to An Bord Pleanála, 64 Marlborough Street, Dublin 1 relating to:

- i. The implications of the proposed development for proper planning and sustainable development, and
- ii. The likely effects on the environment of the proposed development, and
- iii. The likely significant effects of the proposed development on a European site, if carried out.

Any submissions/observations must be received by the Board no later than 5.30 p.m. on 5th April 2024.

Yours sincerely,



Sean Breslin

Senior Consultant, Planning

³ Includes Natura Impact Statement and COMAH Land Use Planning Risk Assessment

07 February 2024

Fáilte Ireland,
88 – 95 Amiens Street,
Dublin 1,
D01 WR86

Dear Sir/Madam,

Proposal: Strategic Infrastructure Development - Proposed Combined Cycle Gas Turbine (570MW) and an Open Cycle Gas Turbine (140MW) Thermal Power Plant and electricity grid connection including 2 no substations and associated buildings, plant, site works services and ancillary development on land within the townlands of Knockdrin, Derrygreenagh, Derryarkin, Derryiron, Ballybeg, Coolcor, Barrysbrook, Clonin, Togher and Coole, Co. Offaly.

On behalf of the applicant, Bord na Móna Powergen Limited¹, we hereby submit a planning application for Strategic Infrastructure Development ('SID') for a Combined Cycle Gas Turbine ('CCGT') and Open Cycle Gas Turbine ('OCGT') Thermal Power Plant, Electricity Grid Connection including 2 no. substations, and associated buildings, plant, site works, services and ancillary development on land within the townlands of Knockdrin, Derrygreenagh, Derryarkin, Derryiron, Ballybeg, Coolcor, Barrysbrook, Clonin, Togher and Coole, Co. Offaly.

The development description reads as follows:

10-year planning permission to develop a Combined Cycle Gas Turbine ('CCGT') and Open Cycle Gas Turbine ('OCGT') Thermal Power Plant, Electricity Grid Connection including 2 no. substations, and associated buildings, plant, site works, services and ancillary development on land within the townlands of Knockdrin, Derrygreenagh, Derryarkin, Derryiron, Ballybeg, Coolcor, Barrysbrook, Clonin, Togher and Coole, Co. Offaly.

The Proposed Development will encompass a Power Plant Area and an Electricity Grid Connection.

The development of the Power Plant Area will include the following:

¹ c/o Bord na Mona, Main Street, Newbridge, Co Kildare

- *Demolition of existing buildings at the Derrygreenagh Works site (Including office building, boiler house, workshops, water tank and storage unit);*
- *Construction of CCGT power plant (570MW) [Including turbine hall and associated buildings, air cooled condensers ('ACC'), Heat Recovery Steam Generator ('HRSG'), air intake, emissions stack (60m high) with Continuous Emissions Monitoring System ('CEMS') and platform];*
- *Ancillary coolers;*
- *Fuel gas performance heating room*
- *Generator transformer and unit auxiliary transformer;*
- *OCGT power plant (140MW) [Including turbine enclosures, air intakes, fin fan coolers, emissions stack (45m high), electrical rooms, main transformer];*
- *Secondary fuel storage tanks and unloading area [Including unloading layby, 2 no. fuel storage tanks, fuel pumping and cleaning plant, fuel forwarding building];*
- *2 no. water abstraction boreholes;*
- *Raw water storage tank;*
- *2 no. demineralised water storage tanks;*
- *Water treatment plant;*
- *Administration building and staff car park;*
- *Wastewater treatment plant;*
- *Workshop and stores building;*
- *Process water treatment plant;*
- *Gas Above Ground Installation ('AGI') compound [Including regulator building, instrumentation kiosks, palisade fencing];*
- *Gas receiving facility [Including gas compressor building, fin fan coolers, pressure reducing station];*
- *Drainage infrastructure [Including surface water attenuation tank, surface water discharge pipeline (Discharging to the Mongagh River), treated process and wastewater discharge pipeline (Discharging to the Yellow River)];*
- *A new site access from the R400 road;*
- *All internal access roads;*
- *Security fencing and gates;*
- *Landscaping*
- *Site works and services*
- *All ancillary infrastructure and plant [Including firefighting systems, fire water pumphouse, raw water pumphouse, emergency diesel generator, propane stores, chemical storage tanks and pumphouse, lube oil storage building, silencers, vents, drains, safety valves, lighting, and pipe gantries];*
- *A permanent Peat and Spoil Deposition Area ('PDA') of approx. 225,000 sq. m. will be located to the south-east of the Power Plant Area.*

The development of the Electricity Grid Connection will include the following:

- *A 220kV substation located to the west of the Power Plant Area and R400 road [Hybrid gas insulated switchgear ('GIS')/air insulated switchgear ('AIS') substation design including switchgear building; control room building; transformer bays; 2. no. lattice gantries (c. 20m high) to support overhead line connection; telecommunications mast (c. 36m high); security fencing; landscaping, new access on to R400 road];*

- 220kV overhead line running for c. 5km to the south of the 220kV substation, facilitated by double circuit suspension pylon towers (13 no.; c. 44m high) and strain pylon towers (6 no.; c. 38m high);
- 220kV line-cable interface compound [Including interface tower gantry (c. 20m high); cable sealing ends; security fencing];
- 220kV underground cable connection running for c. 3.4km to the south [With paved and gated service road and 12 no. joint bays to facilitate construction and servicing];
- A 400kV GIS substation located adjacent to the existing Oldstreet-Woodland 400kV overhead line [Including a 400kV GIS building; 220kV GIS building; transformer compound; 2 no. lattice gantries (c. 28m high) to support overhead line connection to 2 no. new loop-in strain towers (c. 32.5m high) on the Oldstreet-Woodland 400kV line; telecommunications mast (c. 36m high); security fencing; landscaping, access off L1010 road];
- 2 no. permanent Peat Deposition Areas will be provided as part of the Electricity Grid Connection – one to the north of the 400kV substation (c. 75,300 sq. m) and one to the south-west of the 220kV substation (c. 50,200 sq. m.);
- Tree Replanting Areas (c. 17.5 ha.) are proposed within the planning boundary to compensate for all tree felling requirements associated with the Proposed Development.

The application relates to development for the purposes of an activity requiring a license from the Environmental Protection Agency under the Industrial Emissions Directive. It also relates to a Lower Tier COMAH establishment and therefore falls under the requirements of the Control of Major Accident Hazard (COMAH) Regulations, 2015.

An Environmental Impact Assessment Report ('EIAR') and Natura Impact Statement ('NIS') will be submitted with the application.

The Proposed Development provides flexible, dispatchable electricity generation capacity which will help to maintain security of electricity supply into the future, while supporting Ireland in its transition to a low carbon economy in line with National Development Plan and Climate Action Plan objectives. It will help to replace generation capacity that will be lost through the planned retirement of older, more carbon-intensive power stations in the coming years and will facilitate a sustainable transition to renewable fuels such as hydrogen, in line with national commitments for blending renewable fuels into the gas network.

The application is being made directly to An Bord Pleanála² as 'Strategic Infrastructure Development' (SID) under the provisions of Section 37E the Planning and Development Act 2000 (as amended). An Bord Pleanála has required that we notify Fáilte Ireland of the submission of the application.

All documentation for this planning application can be found at www.derrygreenaghpowerplanning.ie, including:

- ABP SID Planning Application Form and Appendices
- Cover Letter and Appendices
- Planning Statement

² An Bord Pleanála, 64 Marlborough Street, Dublin 1

- Drainage Engineering Assessment Report
- Environmental Impact Assessment Report (EIAR)³
- Application Drawings

You are advised that the Board may, in respect of an application for permission, decide to:

- (a) (i) grant the permission/approval,
or
- (ii) make such modifications to the proposed development as it specifies in its decision and grant permission/approval in respect of the proposed development as so modified,
or
- (iii) grant permission/approval in respect of part of the proposed development (with or without specified modifications of the foregoing kind), and any of the above decisions may be subject to or without conditions,
or
- (b) Refuse to grant the permission/approval.

Submissions or Observations may be made only to An Bord Pleanála, 64 Marlborough Street, Dublin 1 relating to:

- i. The implications of the proposed development for proper planning and sustainable development, and
- ii. The likely effects on the environment of the proposed development, and
- iii. The likely significant effects of the proposed development on a European site, if carried out.

Any submissions/observations must be received by the Board no later than 5.30 p.m. on 5th April 2024.

Yours sincerely,



Sean Breslin

Senior Consultant, Planning

³ Includes Natura Impact Statement and COMAH Land Use Planning Risk Assessment

07 February 2024

Health and Safety Authority
Metropolitan Building,
James Joyce Street,
Dublin 1,
D01 KOY8

Dear Sir/Madam,

Proposal: Strategic Infrastructure Development - Proposed Combined Cycle Gas Turbine (570MW) and an Open Cycle Gas Turbine (140MW) Thermal Power Plant and electricity grid connection including 2 no substations and associated buildings, plant, site works services and ancillary development on land within the townlands of Knockdrin, Derrygreenagh, Derryarkin, Derryiron, Ballybeg, Coolcor, Barrysbrook, Clonin, Togher and Coole, Co. Offaly.

On behalf of the applicant, Bord na Móna Powergen Limited¹, we hereby submit a planning application for Strategic Infrastructure Development ('SID') for a Combined Cycle Gas Turbine ('CCGT') and Open Cycle Gas Turbine ('OCGT') Thermal Power Plant, Electricity Grid Connection including 2 no. substations, and associated buildings, plant, site works, services and ancillary development on land within the townlands of Knockdrin, Derrygreenagh, Derryarkin, Derryiron, Ballybeg, Coolcor, Barrysbrook, Clonin, Togher and Coole, Co. Offaly.

The development description reads as follows:

10-year planning permission to develop a Combined Cycle Gas Turbine ('CCGT') and Open Cycle Gas Turbine ('OCGT') Thermal Power Plant, Electricity Grid Connection including 2 no. substations, and associated buildings, plant, site works, services and ancillary development on land within the townlands of Knockdrin, Derrygreenagh, Derryarkin, Derryiron, Ballybeg, Coolcor, Barrysbrook, Clonin, Togher and Coole, Co. Offaly.

The Proposed Development will encompass a Power Plant Area and an Electricity Grid Connection.

The development of the Power Plant Area will include the following:

¹ c/o Bord na Mona, Main Street, Newbridge, Co Kildare

- *Demolition of existing buildings at the Derrygreenagh Works site (Including office building, boiler house, workshops, water tank and storage unit);*
- *Construction of CCGT power plant (570MW) [Including turbine hall and associated buildings, air cooled condensers ('ACC'), Heat Recovery Steam Generator ('HRSG'), air intake, emissions stack (60m high) with Continuous Emissions Monitoring System ('CEMS') and platform];*
- *Ancillary coolers;*
- *Fuel gas performance heating room*
- *Generator transformer and unit auxiliary transformer;*
- *OCGT power plant (140MW) [Including turbine enclosures, air intakes, fin fan coolers, emissions stack (45m high), electrical rooms, main transformer];*
- *Secondary fuel storage tanks and unloading area [Including unloading layby, 2 no. fuel storage tanks, fuel pumping and cleaning plant, fuel forwarding building];*
- *2 no. water abstraction boreholes;*
- *Raw water storage tank;*
- *2 no. demineralised water storage tanks;*
- *Water treatment plant;*
- *Administration building and staff car park;*
- *Wastewater treatment plant;*
- *Workshop and stores building;*
- *Process water treatment plant;*
- *Gas Above Ground Installation ('AGI') compound [Including regulator building, instrumentation kiosks, palisade fencing];*
- *Gas receiving facility [Including gas compressor building, fin fan coolers, pressure reducing station];*
- *Drainage infrastructure [Including surface water attenuation tank, surface water discharge pipeline (Discharging to the Mongagh River), treated process and wastewater discharge pipeline (Discharging to the Yellow River)];*
- *A new site access from the R400 road;*
- *All internal access roads;*
- *Security fencing and gates;*
- *Landscaping*
- *Site works and services*
- *All ancillary infrastructure and plant [Including firefighting systems, fire water pumphouse, raw water pumphouse, emergency diesel generator, propane stores, chemical storage tanks and pumphouse, lube oil storage building, silencers, vents, drains, safety valves, lighting, and pipe gantries];*
- *A permanent Peat and Spoil Deposition Area ('PDA') of approx. 225,000 sq. m. will be located to the south-east of the Power Plant Area.*

The development of the Electricity Grid Connection will include the following:

- *A 220kV substation located to the west of the Power Plant Area and R400 road [Hybrid gas insulated switchgear ('GIS')/air insulated switchgear ('AIS') substation design including switchgear building; control room building; transformer bays; 2. no. lattice gantries (c. 20m high) to support overhead line connection; telecommunications mast (c. 36m high); security fencing; landscaping, new access on to R400 road];*

- 220kV overhead line running for c. 5km to the south of the 220kV substation, facilitated by double circuit suspension pylon towers (13 no.; c. 44m high) and strain pylon towers (6 no.; c. 38m high);
- 220kV line-cable interface compound [Including interface tower gantry (c. 20m high); cable sealing ends; security fencing];
- 220kV underground cable connection running for c. 3.4km to the south [With paved and gated service road and 12 no. joint bays to facilitate construction and servicing];
- A 400kV GIS substation located adjacent to the existing Oldstreet-Woodland 400kV overhead line [Including a 400kV GIS building; 220kV GIS building; transformer compound; 2 no. lattice gantries (c. 28m high) to support overhead line connection to 2 no. new loop-in strain towers (c. 32.5m high) on the Oldstreet-Woodland 400kV line; telecommunications mast (c. 36m high); security fencing; landscaping, access off L1010 road];
- 2 no. permanent Peat Deposition Areas will be provided as part of the Electricity Grid Connection – one to the north of the 400kV substation (c. 75,300 sq. m) and one to the south-west of the 220kV substation (c. 50,200 sq. m.);
- Tree Replanting Areas (c. 17.5 ha.) are proposed within the planning boundary to compensate for all tree felling requirements associated with the Proposed Development.

The application relates to development for the purposes of an activity requiring a license from the Environmental Protection Agency under the Industrial Emissions Directive. It also relates to a Lower Tier COMAH establishment and therefore falls under the requirements of the Control of Major Accident Hazard (COMAH) Regulations, 2015.

An Environmental Impact Assessment Report ('EIAR') and Natura Impact Statement ('NIS') will be submitted with the application.

The Proposed Development provides flexible, dispatchable electricity generation capacity which will help to maintain security of electricity supply into the future, while supporting Ireland in its transition to a low carbon economy in line with National Development Plan and Climate Action Plan objectives. It will help to replace generation capacity that will be lost through the planned retirement of older, more carbon-intensive power stations in the coming years and will facilitate a sustainable transition to renewable fuels such as hydrogen, in line with national commitments for blending renewable fuels into the gas network.

The application is being made directly to An Bord Pleanála² as 'Strategic Infrastructure Development' (SID) under the provisions of Section 37E the Planning and Development Act 2000 (as amended). We have decided to consult the Health and Safety Authority as a prescribed body.

All documentation for this planning application can be found at www.derrygreenaghpowerplanning.ie, including:

- ABP SID Planning Application Form and Appendices
- Cover Letter and Appendices
- Planning Statement
- Drainage Engineering Assessment Report

² An Bord Pleanála, 64 Marlborough Street, Dublin 1

- Environmental Impact Assessment Report (EIAR)³
- Application Drawings

You are advised that the Board may, in respect of an application for permission, decide to:

- (a) (i) grant the permission/approval,
or
(ii) make such modifications to the proposed development as it specifies in its decision and grant permission/approval in respect of the proposed development as so modified,
or
(iii) grant permission/approval in respect of part of the proposed development (with or without specified modifications of the foregoing kind), and any of the above decisions may be subject to or without conditions,
or
- (b) Refuse to grant the permission/approval.

Submissions or Observations may be made only to An Bord Pleanála, 64 Marlborough Street, Dublin 1 relating to:

- i. The implications of the proposed development for proper planning and sustainable development, and
- ii. The likely effects on the environment of the proposed development, and
- iii. The likely significant effects of the proposed development on a European site, if carried out.

Any submissions/observations must be received by the Board no later than 5.30 p.m. on 5th April 2024.

Yours sincerely,



Sean Breslin

Senior Consultant, Planning

³ Includes Natura Impact Statement and COMAH Land Use Planning Risk Assessment

07 February 2024

The Heritage Council,
Áras na hOidhreachta,
Church Lane,
Kilkenny,
R95 X254

Dear Sir/Madam,

Proposal: Strategic Infrastructure Development - Proposed Combined Cycle Gas Turbine (570MW) and an Open Cycle Gas Turbine (140MW) Thermal Power Plant and electricity grid connection including 2 no substations and associated buildings, plant, site works services and ancillary development on land within the townlands of Knockdrin, Derrygreenagh, Derryarkin, Derryiron, Ballybeg, Coolcor, Barrysbrook, Clonin, Togher and Coole, Co. Offaly.

On behalf of the applicant, Bord na Móna Powergen Limited¹, we hereby submit a planning application for Strategic Infrastructure Development ('SID') for a Combined Cycle Gas Turbine ('CCGT') and Open Cycle Gas Turbine ('OCGT') Thermal Power Plant, Electricity Grid Connection including 2 no. substations, and associated buildings, plant, site works, services and ancillary development on land within the townlands of Knockdrin, Derrygreenagh, Derryarkin, Derryiron, Ballybeg, Coolcor, Barrysbrook, Clonin, Togher and Coole, Co. Offaly.

The development description reads as follows:

10-year planning permission to develop a Combined Cycle Gas Turbine ('CCGT') and Open Cycle Gas Turbine ('OCGT') Thermal Power Plant, Electricity Grid Connection including 2 no. substations, and associated buildings, plant, site works, services and ancillary development on land within the townlands of Knockdrin, Derrygreenagh, Derryarkin, Derryiron, Ballybeg, Coolcor, Barrysbrook, Clonin, Togher and Coole, Co. Offaly.

The Proposed Development will encompass a Power Plant Area and an Electricity Grid Connection.

The development of the Power Plant Area will include the following:

¹ c/o Bord na Mona, Main Street, Newbridge, Co Kildare

- Demolition of existing buildings at the Derrygreenagh Works site (Including office building, boiler house, workshops, water tank and storage unit);
- Construction of CCGT power plant (570MW) [Including turbine hall and associated buildings, air cooled condensers ('ACC'), Heat Recovery Steam Generator ('HRSG'), air intake, emissions stack (60m high) with Continuous Emissions Monitoring System ('CEMS') and platform];
- Ancillary coolers;
- Fuel gas performance heating room
- Generator transformer and unit auxiliary transformer;
- OCGT power plant (140MW) [Including turbine enclosures, air intakes, fin fan coolers, emissions stack (45m high), electrical rooms, main transformer];
- Secondary fuel storage tanks and unloading area [Including unloading layby, 2 no. fuel storage tanks, fuel pumping and cleaning plant, fuel forwarding building];
- 2 no. water abstraction boreholes;
- Raw water storage tank;
- 2 no. demineralised water storage tanks;
- Water treatment plant;
- Administration building and staff car park;
- Wastewater treatment plant;
- Workshop and stores building;
- Process water treatment plant;
- Gas Above Ground Installation ('AGI') compound [Including regulator building, instrumentation kiosks, palisade fencing];
- Gas receiving facility [Including gas compressor building, fin fan coolers, pressure reducing station];
- Drainage infrastructure [Including surface water attenuation tank, surface water discharge pipeline (Discharging to the Mongagh River), treated process and wastewater discharge pipeline (Discharging to the Yellow River)];
- A new site access from the R400 road;
- All internal access roads;
- Security fencing and gates;
- Landscaping
- Site works and services
- All ancillary infrastructure and plant [Including firefighting systems, fire water pumphouse, raw water pumphouse, emergency diesel generator, propane stores, chemical storage tanks and pumphouse, lube oil storage building, silencers, vents, drains, safety valves, lighting, and pipe gantries];
- A permanent Peat and Spoil Deposition Area ('PDA') of approx. 225,000 sq. m. will be located to the south-east of the Power Plant Area.

The development of the Electricity Grid Connection will include the following:

- A 220kV substation located to the west of the Power Plant Area and R400 road [Hybrid gas insulated switchgear ('GIS')/air insulated switchgear ('AIS') substation design including switchgear building; control room building; transformer bays; 2. no. lattice gantries (c. 20m high) to support overhead line connection; telecommunications mast (c. 36m high); security fencing; landscaping, new access on to R400 road];

- 220kV overhead line running for c. 5km to the south of the 220kV substation, facilitated by double circuit suspension pylon towers (13 no.; c. 44m high) and strain pylon towers (6 no.; c. 38m high);
- 220kV line-cable interface compound [Including interface tower gantry (c. 20m high); cable sealing ends; security fencing];
- 220kV underground cable connection running for c. 3.4km to the south [With paved and gated service road and 12 no. joint bays to facilitate construction and servicing];
- A 400kV GIS substation located adjacent to the existing Oldstreet-Woodland 400kV overhead line [Including a 400kV GIS building; 220kV GIS building; transformer compound; 2 no. lattice gantries (c. 28m high) to support overhead line connection to 2 no. new loop-in strain towers (c. 32.5m high) on the Oldstreet-Woodland 400kV line; telecommunications mast (c. 36m high); security fencing; landscaping, access off L1010 road];
- 2 no. permanent Peat Deposition Areas will be provided as part of the Electricity Grid Connection – one to the north of the 400kV substation (c. 75,300 sq. m) and one to the south-west of the 220kV substation (c. 50,200 sq. m.);
- Tree Replanting Areas (c. 17.5 ha.) are proposed within the planning boundary to compensate for all tree felling requirements associated with the Proposed Development.

The application relates to development for the purposes of an activity requiring a license from the Environmental Protection Agency under the Industrial Emissions Directive. It also relates to a Lower Tier COMAH establishment and therefore falls under the requirements of the Control of Major Accident Hazard (COMAH) Regulations, 2015.

An Environmental Impact Assessment Report ('EIAR') and Natura Impact Statement ('NIS') will be submitted with the application.

The Proposed Development provides flexible, dispatchable electricity generation capacity which will help to maintain security of electricity supply into the future, while supporting Ireland in its transition to a low carbon economy in line with National Development Plan and Climate Action Plan objectives. It will help to replace generation capacity that will be lost through the planned retirement of older, more carbon-intensive power stations in the coming years and will facilitate a sustainable transition to renewable fuels such as hydrogen, in line with national commitments for blending renewable fuels into the gas network.

The application is being made directly to An Bord Pleanála² as 'Strategic Infrastructure Development' (SID) under the provisions of Section 37E the Planning and Development Act 2000 (as amended). An Bord Pleanála has required that we notify the Heritage Council of the submission of the application.

All documentation for this planning application can be found at www.derrygreenaghpowerplanning.ie, including:

- ABP SID Planning Application Form and Appendices
- Cover Letter and Appendices
- Planning Statement

² An Bord Pleanála, 64 Marlborough Street, Dublin 1

- Drainage Engineering Assessment Report
- Environmental Impact Assessment Report (EIAR)³
- Application Drawings

You are advised that the Board may, in respect of an application for permission, decide to:

- (a) (i) grant the permission/approval,
or
- (ii) make such modifications to the proposed development as it specifies in its decision and grant permission/approval in respect of the proposed development as so modified,
or
- (iii) grant permission/approval in respect of part of the proposed development (with or without specified modifications of the foregoing kind), and any of the above decisions may be subject to or without conditions,
or
- (b) Refuse to grant the permission/approval.

Submissions or Observations may be made only to An Bord Pleanála, 64 Marlborough Street, Dublin 1 relating to:

- i. The implications of the proposed development for proper planning and sustainable development, and
- ii. The likely effects on the environment of the proposed development, and
- iii. The likely significant effects of the proposed development on a European site, if carried out.

Any submissions/observations must be received by the Board no later than 5.30 p.m. on 5th April 2024.

Yours sincerely,



Sean Breslin

Senior Consultant, Planning

³ Includes Natura Impact Statement and COMAH Land Use Planning Risk Assessment

07 February 2024

Inland Fisheries Ireland,
3044 Lake Drive,
Citywest Business Campus,
Dublin,
D24 CK66.

Dear Sir/Madam,

Proposal: Strategic Infrastructure Development - Proposed Combined Cycle Gas Turbine (570MW) and an Open Cycle Gas Turbine (140MW) Thermal Power Plant and electricity grid connection including 2 no substations and associated buildings, plant, site works services and ancillary development on land within the townlands of Knockdrin, Derrygreenagh, Derryarkin, Derryiron, Ballybeg, Coolcor, Barrysbrook, Clonin, Togher and Coole, Co. Offaly.

On behalf of the applicant, Bord na Móna Powergen Limited¹, we hereby submit a planning application for Strategic Infrastructure Development ('SID') for a Combined Cycle Gas Turbine ('CCGT') and Open Cycle Gas Turbine ('OCGT') Thermal Power Plant, Electricity Grid Connection including 2 no. substations, and associated buildings, plant, site works, services and ancillary development on land within the townlands of Knockdrin, Derrygreenagh, Derryarkin, Derryiron, Ballybeg, Coolcor, Barrysbrook, Clonin, Togher and Coole, Co. Offaly.

The development description reads as follows:

10-year planning permission to develop a Combined Cycle Gas Turbine ('CCGT') and Open Cycle Gas Turbine ('OCGT') Thermal Power Plant, Electricity Grid Connection including 2 no. substations, and associated buildings, plant, site works, services and ancillary development on land within the townlands of Knockdrin, Derrygreenagh, Derryarkin, Derryiron, Ballybeg, Coolcor, Barrysbrook, Clonin, Togher and Coole, Co. Offaly.

The Proposed Development will encompass a Power Plant Area and an Electricity Grid Connection.

The development of the Power Plant Area will include the following:

¹ c/o Bord na Mona, Main Street, Newbridge, Co Kildare

- *Demolition of existing buildings at the Derrygreenagh Works site (Including office building, boiler house, workshops, water tank and storage unit);*
- *Construction of CCGT power plant (570MW) [Including turbine hall and associated buildings, air cooled condensers ('ACC'), Heat Recovery Steam Generator ('HRSG'), air intake, emissions stack (60m high) with Continuous Emissions Monitoring System ('CEMS') and platform];*
- *Ancillary coolers;*
- *Fuel gas performance heating room*
- *Generator transformer and unit auxiliary transformer;*
- *OCGT power plant (140MW) [Including turbine enclosures, air intakes, fin fan coolers, emissions stack (45m high), electrical rooms, main transformer];*
- *Secondary fuel storage tanks and unloading area [Including unloading layby, 2 no. fuel storage tanks, fuel pumping and cleaning plant, fuel forwarding building];*
- *2 no. water abstraction boreholes;*
- *Raw water storage tank;*
- *2 no. demineralised water storage tanks;*
- *Water treatment plant;*
- *Administration building and staff car park;*
- *Wastewater treatment plant;*
- *Workshop and stores building;*
- *Process water treatment plant;*
- *Gas Above Ground Installation ('AGI') compound [Including regulator building, instrumentation kiosks, palisade fencing];*
- *Gas receiving facility [Including gas compressor building, fin fan coolers, pressure reducing station];*
- *Drainage infrastructure [Including surface water attenuation tank, surface water discharge pipeline (Discharging to the Mongagh River), treated process and wastewater discharge pipeline (Discharging to the Yellow River)];*
- *A new site access from the R400 road;*
- *All internal access roads;*
- *Security fencing and gates;*
- *Landscaping*
- *Site works and services*
- *All ancillary infrastructure and plant [Including firefighting systems, fire water pumphouse, raw water pumphouse, emergency diesel generator, propane stores, chemical storage tanks and pumphouse, lube oil storage building, silencers, vents, drains, safety valves, lighting, and pipe gantries];*
- *A permanent Peat and Spoil Deposition Area ('PDA') of approx. 225,000 sq. m. will be located to the south-east of the Power Plant Area.*

The development of the Electricity Grid Connection will include the following:

- *A 220kV substation located to the west of the Power Plant Area and R400 road [Hybrid gas insulated switchgear ('GIS')/air insulated switchgear ('AIS') substation design including switchgear building; control room building; transformer bays; 2. no. lattice gantries (c. 20m high) to support overhead line connection; telecommunications mast (c. 36m high); security fencing; landscaping, new access on to R400 road];*

- 220kV overhead line running for c. 5km to the south of the 220kV substation, facilitated by double circuit suspension pylon towers (13 no.; c. 44m high) and strain pylon towers (6 no.; c. 38m high);
- 220kV line-cable interface compound [Including interface tower gantry (c. 20m high); cable sealing ends; security fencing];
- 220kV underground cable connection running for c. 3.4km to the south [With paved and gated service road and 12 no. joint bays to facilitate construction and servicing];
- A 400kV GIS substation located adjacent to the existing Oldstreet-Woodland 400kV overhead line [Including a 400kV GIS building; 220kV GIS building; transformer compound; 2 no. lattice gantries (c. 28m high) to support overhead line connection to 2 no. new loop-in strain towers (c. 32.5m high) on the Oldstreet-Woodland 400kV line; telecommunications mast (c. 36m high); security fencing; landscaping, access off L1010 road];
- 2 no. permanent Peat Deposition Areas will be provided as part of the Electricity Grid Connection – one to the north of the 400kV substation (c. 75,300 sq. m) and one to the south-west of the 220kV substation (c. 50,200 sq. m.);
- Tree Replanting Areas (c. 17.5 ha.) are proposed within the planning boundary to compensate for all tree felling requirements associated with the Proposed Development.

The application relates to development for the purposes of an activity requiring a license from the Environmental Protection Agency under the Industrial Emissions Directive. It also relates to a Lower Tier COMAH establishment and therefore falls under the requirements of the Control of Major Accident Hazard (COMAH) Regulations, 2015.

An Environmental Impact Assessment Report ('EIAR') and Natura Impact Statement ('NIS') will be submitted with the application.

The Proposed Development provides flexible, dispatchable electricity generation capacity which will help to maintain security of electricity supply into the future, while supporting Ireland in its transition to a low carbon economy in line with National Development Plan and Climate Action Plan objectives. It will help to replace generation capacity that will be lost through the planned retirement of older, more carbon-intensive power stations in the coming years and will facilitate a sustainable transition to renewable fuels such as hydrogen, in line with national commitments for blending renewable fuels into the gas network.

The application is being made directly to An Bord Pleanála² as 'Strategic Infrastructure Development' (SID) under the provisions of Section 37E the Planning and Development Act 2000 (as amended). An Bord Pleanála has required that we notify Inland Fisheries Ireland of the submission of the application.

All documentation for this planning application can be found at www.derrygreenaghpowerplanning.ie, including:

- ABP SID Planning Application Form and Appendices
- Cover Letter and Appendices
- Planning Statement

² An Bord Pleanála, 64 Marlborough Street, Dublin 1

- Drainage Engineering Assessment Report
- Environmental Impact Assessment Report (EIAR)³
- Application Drawings

You are advised that the Board may, in respect of an application for permission, decide to:

- (a) (i) grant the permission/approval,
or
- (ii) make such modifications to the proposed development as it specifies in its decision and grant permission/approval in respect of the proposed development as so modified,
or
- (iii) grant permission/approval in respect of part of the proposed development (with or without specified modifications of the foregoing kind), and any of the above decisions may be subject to or without conditions,
or
- (b) Refuse to grant the permission/approval.

Submissions or Observations may be made only to An Bord Pleanála, 64 Marlborough Street, Dublin 1 relating to:

- i. The implications of the proposed development for proper planning and sustainable development, and
- ii. The likely effects on the environment of the proposed development, and
- iii. The likely significant effects of the proposed development on a European site, if carried out.

Any submissions/observations must be received by the Board no later than 5.30 p.m. on 5th April 2024.

Yours sincerely,



Sean Breslin

Senior Consultant, Planning

³ Includes Natura Impact Statement and COMAH Land Use Planning Risk Assessment

07 February 2024

Irish Water,
Development Management Planning,
Irish Water,
Colvill House,
24-26 Talbot Street,
Dublin 1,

Dear Sir/Madam,

Proposal: Strategic Infrastructure Development - Proposed Combined Cycle Gas Turbine (570MW) and an Open Cycle Gas Turbine (140MW) Thermal Power Plant and electricity grid connection including 2 no substations and associated buildings, plant, site works services and ancillary development on land within the townlands of Knockdrin, Derrygreenagh, Derryarkin, Derryiron, Ballybeg, Coolcor, Barrysbrook, Clonin, Togher and Coole, Co. Offaly.

On behalf of the applicant, Bord na Móna Powergen Limited¹, we hereby submit a planning application for Strategic Infrastructure Development ('SID') for a Combined Cycle Gas Turbine ('CCGT') and Open Cycle Gas Turbine ('OCGT') Thermal Power Plant, Electricity Grid Connection including 2 no. substations, and associated buildings, plant, site works, services and ancillary development on land within the townlands of Knockdrin, Derrygreenagh, Derryarkin, Derryiron, Ballybeg, Coolcor, Barrysbrook, Clonin, Togher and Coole, Co. Offaly.

The development description reads as follows:

10-year planning permission to develop a Combined Cycle Gas Turbine ('CCGT') and Open Cycle Gas Turbine ('OCGT') Thermal Power Plant, Electricity Grid Connection including 2 no. substations, and associated buildings, plant, site works, services and ancillary development on land within the townlands of Knockdrin, Derrygreenagh, Derryarkin, Derryiron, Ballybeg, Coolcor, Barrysbrook, Clonin, Togher and Coole, Co. Offaly.

The Proposed Development will encompass a Power Plant Area and an Electricity Grid Connection.

¹ c/o Bord na Mona, Main Street, Newbridge, Co Kildare

The development of the Power Plant Area will include the following:

- *Demolition of existing buildings at the Derrygreenagh Works site (Including office building, boiler house, workshops, water tank and storage unit);*
- *Construction of CCGT power plant (570MW) [Including turbine hall and associated buildings, air cooled condensers ('ACC'), Heat Recovery Steam Generator ('HRSG'), air intake, emissions stack (60m high) with Continuous Emissions Monitoring System ('CEMS') and platform];*
- *Ancillary coolers;*
- *Fuel gas performance heating room*
- *Generator transformer and unit auxiliary transformer;*
- *OCGT power plant (140MW) [Including turbine enclosures, air intakes, fin fan coolers, emissions stack (45m high), electrical rooms, main transformer];*
- *Secondary fuel storage tanks and unloading area [Including unloading layby, 2 no. fuel storage tanks, fuel pumping and cleaning plant, fuel forwarding building];*
- *2 no. water abstraction boreholes;*
- *Raw water storage tank;*
- *2 no. demineralised water storage tanks;*
- *Water treatment plant;*
- *Administration building and staff car park;*
- *Wastewater treatment plant;*
- *Workshop and stores building;*
- *Process water treatment plant;*
- *Gas Above Ground Installation ('AGI') compound [Including regulator building, instrumentation kiosks, palisade fencing];*
- *Gas receiving facility [Including gas compressor building, fin fan coolers, pressure reducing station];*
- *Drainage infrastructure [Including surface water attenuation tank, surface water discharge pipeline (Discharging to the Mongagh River), treated process and wastewater discharge pipeline (Discharging to the Yellow River)];*
- *A new site access from the R400 road;*
- *All internal access roads;*
- *Security fencing and gates;*
- *Landscaping*
- *Site works and services*
- *All ancillary infrastructure and plant [Including firefighting systems, fire water pumphouse, raw water pumphouse, emergency diesel generator, propane stores, chemical storage tanks and pumphouse, lube oil storage building, silencers, vents, drains, safety valves, lighting, and pipe gantries];*
- *A permanent Peat and Spoil Deposition Area ('PDA') of approx. 225,000 sq. m. will be located to the south-east of the Power Plant Area.*

The development of the Electricity Grid Connection will include the following:

- *A 220kV substation located to the west of the Power Plant Area and R400 road [Hybrid gas insulated switchgear ('GIS')/air insulated switchgear ('AIS') substation design including switchgear building; control room building; transformer bays; 2. no. lattice gantries (c. 20m*

high) to support overhead line connection; telecommunications mast (c. 36m high); security fencing; landscaping, new access on to R400 road];

- *220kV overhead line running for c. 5km to the south of the 220kV substation, facilitated by double circuit suspension pylon towers (13 no.; c. 44m high) and strain pylon towers (6 no.; c. 38m high);*
- *220kV line-cable interface compound [Including interface tower gantry (c. 20m high); cable sealing ends; security fencing];*
- *220kV underground cable connection running for c. 3.4km to the south [With paved and gated service road and 12 no. joint bays to facilitate construction and servicing];*
- *A 400kV GIS substation located adjacent to the existing Oldstreet-Woodland 400kV overhead line [Including a 400kV GIS building; 220kV GIS building; transformer compound; 2 no. lattice gantries (c. 28m high) to support overhead line connection to 2 no. new loop-in strain towers (c. 32.5m high) on the Oldstreet-Woodland 400kV line; telecommunications mast (c. 36m high); security fencing; landscaping, access off L1010 road];*
- *2 no. permanent Peat Deposition Areas will be provided as part of the Electricity Grid Connection – one to the north of the 400kV substation (c. 75,300 sq. m) and one to the south-west of the 220kV substation (c. 50,200 sq. m.);*
- *Tree Replanting Areas (c. 17.5 ha.) are proposed within the planning boundary to compensate for all tree felling requirements associated with the Proposed Development.*

The application relates to development for the purposes of an activity requiring a license from the Environmental Protection Agency under the Industrial Emissions Directive. It also relates to a Lower Tier COMAH establishment and therefore falls under the requirements of the Control of Major Accident Hazard (COMAH) Regulations, 2015.

An Environmental Impact Assessment Report ('EIAR') and Natura Impact Statement ('NIS') will be submitted with the application.

The Proposed Development provides flexible, dispatchable electricity generation capacity which will help to maintain security of electricity supply into the future, while supporting Ireland in its transition to a low carbon economy in line with National Development Plan and Climate Action Plan objectives. It will help to replace generation capacity that will be lost through the planned retirement of older, more carbon-intensive power stations in the coming years and will facilitate a sustainable transition to renewable fuels such as hydrogen, in line with national commitments for blending renewable fuels into the gas network.

The application is being made directly to An Bord Pleanála² as 'Strategic Infrastructure Development'(SID) under the provisions of Section 37E the Planning and Development Act 2000 (as amended). An Bord Pleanála has required that we notify Irish Water of the submission of the application.

All documentation for this planning application can be found at www.derrygreenaghpowerplanning.ie , including:

- ABP SID Planning Application Form and Appendices

² An Bord Pleanála, 64 Marlborough Street, Dublin 1

- Cover Letter and Appendices
- Planning Statement
- Drainage Engineering Assessment Report
- Environmental Impact Assessment Report (EIAR)³
- Application Drawings

You are advised that the Board may, in respect of an application for permission, decide to:

- (a) (i) grant the permission/approval,
or
- (ii) make such modifications to the proposed development as it specifies in its decision and grant permission/approval in respect of the proposed development as so modified,
or
- (iii) grant permission/approval in respect of part of the proposed development (with or without specified modifications of the foregoing kind), and any of the above decisions may be subject to or without conditions,
or
- (b) Refuse to grant the permission/approval.

Submissions or Observations may be made only to An Bord Pleanála, 64 Marlborough Street, Dublin 1 relating to:

- i. The implications of the proposed development for proper planning and sustainable development, and
- ii. The likely effects on the environment of the proposed development, and
- iii. The likely significant effects of the proposed development on a European site, if carried out.

Any submissions/observations must be received by the Board no later than 5.30 p.m. on 5th April 2024.

Yours sincerely,



Sean Breslin

Senior Consultant, Planning

³ Includes Natura Impact Statement and COMAH Land Use Planning Risk Assessment

07 February 2024

Department of Housing, Local Government and Heritage,
Custom House,
Dublin
D01 W6X0

Dear Sir/Madam,

Proposal: Strategic Infrastructure Development - Proposed Combined Cycle Gas Turbine (570MW) and an Open Cycle Gas Turbine (140MW) Thermal Power Plant and electricity grid connection including 2 no substations and associated buildings, plant, site works services and ancillary development on land within the townlands of Knockdrin, Derrygreenagh, Derryarkin, Derryiron, Ballybeg, Coolcor, Barrysbrook, Clonin, Togher and Coole, Co. Offaly.

On behalf of the applicant, Bord na Móna Powergen Limited¹, we hereby submit a planning application for Strategic Infrastructure Development ('SID') for a Combined Cycle Gas Turbine ('CCGT') and Open Cycle Gas Turbine ('OCGT') Thermal Power Plant, Electricity Grid Connection including 2 no. substations, and associated buildings, plant, site works, services and ancillary development on land within the townlands of Knockdrin, Derrygreenagh, Derryarkin, Derryiron, Ballybeg, Coolcor, Barrysbrook, Clonin, Togher and Coole, Co. Offaly.

The development description reads as follows:

10-year planning permission to develop a Combined Cycle Gas Turbine ('CCGT') and Open Cycle Gas Turbine ('OCGT') Thermal Power Plant, Electricity Grid Connection including 2 no. substations, and associated buildings, plant, site works, services and ancillary development on land within the townlands of Knockdrin, Derrygreenagh, Derryarkin, Derryiron, Ballybeg, Coolcor, Barrysbrook, Clonin, Togher and Coole, Co. Offaly.

The Proposed Development will encompass a Power Plant Area and an Electricity Grid Connection.

The development of the Power Plant Area will include the following:

¹ c/o Bord na Mona, Main Street, Newbridge, Co Kildare

- *Demolition of existing buildings at the Derrygreenagh Works site (Including office building, boiler house, workshops, water tank and storage unit);*
- *Construction of CCGT power plant (570MW) [Including turbine hall and associated buildings, air cooled condensers ('ACC'), Heat Recovery Steam Generator ('HRSG'), air intake, emissions stack (60m high) with Continuous Emissions Monitoring System ('CEMS') and platform];*
- *Ancillary coolers;*
- *Fuel gas performance heating room*
- *Generator transformer and unit auxiliary transformer;*
- *OCGT power plant (140MW) [Including turbine enclosures, air intakes, fin fan coolers, emissions stack (45m high), electrical rooms, main transformer];*
- *Secondary fuel storage tanks and unloading area [Including unloading layby, 2 no. fuel storage tanks, fuel pumping and cleaning plant, fuel forwarding building];*
- *2 no. water abstraction boreholes;*
- *Raw water storage tank;*
- *2 no. demineralised water storage tanks;*
- *Water treatment plant;*
- *Administration building and staff car park;*
- *Wastewater treatment plant;*
- *Workshop and stores building;*
- *Process water treatment plant;*
- *Gas Above Ground Installation ('AGI') compound [Including regulator building, instrumentation kiosks, palisade fencing];*
- *Gas receiving facility [Including gas compressor building, fin fan coolers, pressure reducing station];*
- *Drainage infrastructure [Including surface water attenuation tank, surface water discharge pipeline (Discharging to the Mongagh River), treated process and wastewater discharge pipeline (Discharging to the Yellow River)];*
- *A new site access from the R400 road;*
- *All internal access roads;*
- *Security fencing and gates;*
- *Landscaping*
- *Site works and services*
- *All ancillary infrastructure and plant [Including firefighting systems, fire water pumphouse, raw water pumphouse, emergency diesel generator, propane stores, chemical storage tanks and pumphouse, lube oil storage building, silencers, vents, drains, safety valves, lighting, and pipe gantries];*
- *A permanent Peat and Spoil Deposition Area ('PDA') of approx. 225,000 sq. m. will be located to the south-east of the Power Plant Area.*

The development of the Electricity Grid Connection will include the following:

- *A 220kV substation located to the west of the Power Plant Area and R400 road [Hybrid gas insulated switchgear ('GIS')/air insulated switchgear ('AIS') substation design including switchgear building; control room building; transformer bays; 2. no. lattice gantries (c. 20m high) to support overhead line connection; telecommunications mast (c. 36m high); security fencing; landscaping, new access on to R400 road];*

- 220kV overhead line running for c. 5km to the south of the 220kV substation, facilitated by double circuit suspension pylon towers (13 no.; c. 44m high) and strain pylon towers (6 no.; c. 38m high);
- 220kV line-cable interface compound [Including interface tower gantry (c. 20m high); cable sealing ends; security fencing];
- 220kV underground cable connection running for c. 3.4km to the south [With paved and gated service road and 12 no. joint bays to facilitate construction and servicing];
- A 400kV GIS substation located adjacent to the existing Oldstreet-Woodland 400kV overhead line [Including a 400kV GIS building; 220kV GIS building; transformer compound; 2 no. lattice gantries (c. 28m high) to support overhead line connection to 2 no. new loop-in strain towers (c. 32.5m high) on the Oldstreet-Woodland 400kV line; telecommunications mast (c. 36m high); security fencing; landscaping, access off L1010 road];
- 2 no. permanent Peat Deposition Areas will be provided as part of the Electricity Grid Connection – one to the north of the 400kV substation (c. 75,300 sq. m) and one to the south-west of the 220kV substation (c. 50,200 sq. m.);
- Tree Replanting Areas (c. 17.5 ha.) are proposed within the planning boundary to compensate for all tree felling requirements associated with the Proposed Development.

The application relates to development for the purposes of an activity requiring a license from the Environmental Protection Agency under the Industrial Emissions Directive. It also relates to a Lower Tier COMAH establishment and therefore falls under the requirements of the Control of Major Accident Hazard (COMAH) Regulations, 2015.

An Environmental Impact Assessment Report ('EIAR') and Natura Impact Statement ('NIS') will be submitted with the application.

The Proposed Development provides flexible, dispatchable electricity generation capacity which will help to maintain security of electricity supply into the future, while supporting Ireland in its transition to a low carbon economy in line with National Development Plan and Climate Action Plan objectives. It will help to replace generation capacity that will be lost through the planned retirement of older, more carbon-intensive power stations in the coming years and will facilitate a sustainable transition to renewable fuels such as hydrogen, in line with national commitments for blending renewable fuels into the gas network.

The application is being made directly to An Bord Pleanála² as 'Strategic Infrastructure Development' (SID) under the provisions of Section 37E the Planning and Development Act 2000 (as amended). An Bord Pleanála has required that we notify the Department of Housing, Local Government and Heritage of the submission of the application.

All documentation for this planning application can be found at www.derrygreenaghpowerplanning.ie, including:

- ABP SID Planning Application Form and Appendices
- Cover Letter and Appendices
- Planning Statement

² An Bord Pleanála, 64 Marlborough Street, Dublin 1

- Drainage Engineering Assessment Report
- Environmental Impact Assessment Report (EIAR)³
- Application Drawings

You are advised that the Board may, in respect of an application for permission, decide to:

- (a) (i) grant the permission/approval,
or
- (ii) make such modifications to the proposed development as it specifies in its decision and grant permission/approval in respect of the proposed development as so modified,
or
- (iii) grant permission/approval in respect of part of the proposed development (with or without specified modifications of the foregoing kind), and any of the above decisions may be subject to or without conditions,
or
- (b) Refuse to grant the permission/approval.

Submissions or Observations may be made only to An Bord Pleanála, 64 Marlborough Street, Dublin 1 relating to:

- i. The implications of the proposed development for proper planning and sustainable development, and
- ii. The likely effects on the environment of the proposed development, and
- iii. The likely significant effects of the proposed development on a European site, if carried out.

Any submissions/observations must be received by the Board no later than 5.30 p.m. on 5th April 2024.

Yours sincerely,



Sean Breslin

Senior Consultant, Planning

³ Includes Natura Impact Statement and COMAH Land Use Planning Risk Assessment

07 February 2024

Minister for the Environment, Climate and Communications,
29-31 Adelaide Road,
Dublin 2,
D02 X285

Dear Sir/Madam,

Proposal: Strategic Infrastructure Development - Proposed Combined Cycle Gas Turbine (570MW) and an Open Cycle Gas Turbine (140MW) Thermal Power Plant and electricity grid connection including 2 no substations and associated buildings, plant, site works services and ancillary development on land within the townlands of Knockdrin, Derrygreenagh, Derryarkin, Derryiron, Ballybeg, Coolcor, Barrysbrook, Clonin, Togher and Coole, Co. Offaly.

On behalf of the applicant, Bord na Móna Powergen Limited¹, we hereby submit a planning application for Strategic Infrastructure Development ('SID') for a Combined Cycle Gas Turbine ('CCGT') and Open Cycle Gas Turbine ('OCGT') Thermal Power Plant, Electricity Grid Connection including 2 no. substations, and associated buildings, plant, site works, services and ancillary development on land within the townlands of Knockdrin, Derrygreenagh, Derryarkin, Derryiron, Ballybeg, Coolcor, Barrysbrook, Clonin, Togher and Coole, Co. Offaly.

The development description reads as follows:

10-year planning permission to develop a Combined Cycle Gas Turbine ('CCGT') and Open Cycle Gas Turbine ('OCGT') Thermal Power Plant, Electricity Grid Connection including 2 no. substations, and associated buildings, plant, site works, services and ancillary development on land within the townlands of Knockdrin, Derrygreenagh, Derryarkin, Derryiron, Ballybeg, Coolcor, Barrysbrook, Clonin, Togher and Coole, Co. Offaly.

The Proposed Development will encompass a Power Plant Area and an Electricity Grid Connection.

The development of the Power Plant Area will include the following:

¹ c/o Bord na Mona, Main Street, Newbridge, Co Kildare

- *Demolition of existing buildings at the Derrygreenagh Works site (Including office building, boiler house, workshops, water tank and storage unit);*
- *Construction of CCGT power plant (570MW) [Including turbine hall and associated buildings, air cooled condensers ('ACC'), Heat Recovery Steam Generator ('HRSG'), air intake, emissions stack (60m high) with Continuous Emissions Monitoring System ('CEMS') and platform];*
- *Ancillary coolers;*
- *Fuel gas performance heating room*
- *Generator transformer and unit auxiliary transformer;*
- *OCGT power plant (140MW) [Including turbine enclosures, air intakes, fin fan coolers, emissions stack (45m high), electrical rooms, main transformer];*
- *Secondary fuel storage tanks and unloading area [Including unloading layby, 2 no. fuel storage tanks, fuel pumping and cleaning plant, fuel forwarding building];*
- *2 no. water abstraction boreholes;*
- *Raw water storage tank;*
- *2 no. demineralised water storage tanks;*
- *Water treatment plant;*
- *Administration building and staff car park;*
- *Wastewater treatment plant;*
- *Workshop and stores building;*
- *Process water treatment plant;*
- *Gas Above Ground Installation ('AGI') compound [Including regulator building, instrumentation kiosks, palisade fencing];*
- *Gas receiving facility [Including gas compressor building, fin fan coolers, pressure reducing station];*
- *Drainage infrastructure [Including surface water attenuation tank, surface water discharge pipeline (Discharging to the Mongagh River), treated process and wastewater discharge pipeline (Discharging to the Yellow River)];*
- *A new site access from the R400 road;*
- *All internal access roads;*
- *Security fencing and gates;*
- *Landscaping*
- *Site works and services*
- *All ancillary infrastructure and plant [Including firefighting systems, fire water pumphouse, raw water pumphouse, emergency diesel generator, propane stores, chemical storage tanks and pumphouse, lube oil storage building, silencers, vents, drains, safety valves, lighting, and pipe gantries];*
- *A permanent Peat and Spoil Deposition Area ('PDA') of approx. 225,000 sq. m. will be located to the south-east of the Power Plant Area.*

The development of the Electricity Grid Connection will include the following:

- *A 220kV substation located to the west of the Power Plant Area and R400 road [Hybrid gas insulated switchgear ('GIS')/air insulated switchgear ('AIS') substation design including switchgear building; control room building; transformer bays; 2. no. lattice gantries (c. 20m high) to support overhead line connection; telecommunications mast (c. 36m high); security fencing; landscaping, new access on to R400 road];*

- 220kV overhead line running for c. 5km to the south of the 220kV substation, facilitated by double circuit suspension pylon towers (13 no.; c. 44m high) and strain pylon towers (6 no.; c. 38m high);
- 220kV line-cable interface compound [Including interface tower gantry (c. 20m high); cable sealing ends; security fencing];
- 220kV underground cable connection running for c. 3.4km to the south [With paved and gated service road and 12 no. joint bays to facilitate construction and servicing];
- A 400kV GIS substation located adjacent to the existing Oldstreet-Woodland 400kV overhead line [Including a 400kV GIS building; 220kV GIS building; transformer compound; 2 no. lattice gantries (c. 28m high) to support overhead line connection to 2 no. new loop-in strain towers (c. 32.5m high) on the Oldstreet-Woodland 400kV line; telecommunications mast (c. 36m high); security fencing; landscaping, access off L1010 road];
- 2 no. permanent Peat Deposition Areas will be provided as part of the Electricity Grid Connection – one to the north of the 400kV substation (c. 75,300 sq. m) and one to the south-west of the 220kV substation (c. 50,200 sq. m.);
- Tree Replanting Areas (c. 17.5 ha.) are proposed within the planning boundary to compensate for all tree felling requirements associated with the Proposed Development.

The application relates to development for the purposes of an activity requiring a license from the Environmental Protection Agency under the Industrial Emissions Directive. It also relates to a Lower Tier COMAH establishment and therefore falls under the requirements of the Control of Major Accident Hazard (COMAH) Regulations, 2015.

An Environmental Impact Assessment Report ('EIAR') and Natura Impact Statement ('NIS') will be submitted with the application.

The Proposed Development provides flexible, dispatchable electricity generation capacity which will help to maintain security of electricity supply into the future, while supporting Ireland in its transition to a low carbon economy in line with National Development Plan and Climate Action Plan objectives. It will help to replace generation capacity that will be lost through the planned retirement of older, more carbon-intensive power stations in the coming years and will facilitate a sustainable transition to renewable fuels such as hydrogen, in line with national commitments for blending renewable fuels into the gas network.

The application is being made directly to An Bord Pleanála² as 'Strategic Infrastructure Development' (SID) under the provisions of Section 37E the Planning and Development Act 2000 (as amended). An Bord Pleanála has required that we notify the Minister for the Environment, Climate and Communications of the submission of the application.

All documentation for this planning application can be found at www.derrygreenaghpowerplanning.ie, including:

- ABP SID Planning Application Form and Appendices
- Cover Letter and Appendices
- Planning Statement

² An Bord Pleanála, 64 Marlborough Street, Dublin 1

- Drainage Engineering Assessment Report
- Environmental Impact Assessment Report (EIAR)³
- Application Drawings

You are advised that the Board may, in respect of an application for permission, decide to:

- (a) (i) grant the permission/approval,
or
- (ii) make such modifications to the proposed development as it specifies in its decision and grant permission/approval in respect of the proposed development as so modified,
or
- (iii) grant permission/approval in respect of part of the proposed development (with or without specified modifications of the foregoing kind), and any of the above decisions may be subject to or without conditions,
or
- (b) Refuse to grant the permission/approval.

Submissions or Observations may be made only to An Bord Pleanála, 64 Marlborough Street, Dublin 1 relating to:

- i. The implications of the proposed development for proper planning and sustainable development, and
- ii. The likely effects on the environment of the proposed development, and
- iii. The likely significant effects of the proposed development on a European site, if carried out.

Any submissions/observations must be received by the Board no later than 5.30 p.m. on 5th April 2024.

Yours sincerely,



Sean Breslin

Senior Consultant, Planning

³ Includes Natura Impact Statement and COMAH Land Use Planning Risk Assessment

07 February 2024

Offaly County Council,
Áras an Chonatae,
Charleville Road,
Tullamore,
Co. Offaly,
R35 F893

Dear Sir/Madam,

Proposal: Strategic Infrastructure Development - Proposed Combined Cycle Gas Turbine (570MW) and an Open Cycle Gas Turbine (140MW) Thermal Power Plant and electricity grid connection including 2 no substations and associated buildings, plant, site works services and ancillary development on land within the townlands of Knockdrin, Derrygreenagh, Derryarkin, Derryiron, Ballybeg, Coolcor, Barrysbrook, Clonin, Togher and Coole, Co. Offaly.

On behalf of the applicant, Bord na Móna Powergen Limited¹, we hereby submit a planning application for Strategic Infrastructure Development ('SID') for a Combined Cycle Gas Turbine ('CCGT') and Open Cycle Gas Turbine ('OCGT') Thermal Power Plant, Electricity Grid Connection including 2 no. substations, and associated buildings, plant, site works, services and ancillary development on land within the townlands of Knockdrin, Derrygreenagh, Derryarkin, Derryiron, Ballybeg, Coolcor, Barrysbrook, Clonin, Togher and Coole, Co. Offaly.

The development description reads as follows:

10-year planning permission to develop a Combined Cycle Gas Turbine ('CCGT') and Open Cycle Gas Turbine ('OCGT') Thermal Power Plant, Electricity Grid Connection including 2 no. substations, and associated buildings, plant, site works, services and ancillary development on land within the townlands of Knockdrin, Derrygreenagh, Derryarkin, Derryiron, Ballybeg, Coolcor, Barrysbrook, Clonin, Togher and Coole, Co. Offaly.

The Proposed Development will encompass a Power Plant Area and an Electricity Grid Connection.

¹ c/o Bord na Mona, Main Street, Newbridge, Co Kildare

The development of the Power Plant Area will include the following:

- *Demolition of existing buildings at the Derrygreenagh Works site (Including office building, boiler house, workshops, water tank and storage unit);*
- *Construction of CCGT power plant (570MW) [Including turbine hall and associated buildings, air cooled condensers ('ACC'), Heat Recovery Steam Generator ('HRSG'), air intake, emissions stack (60m high) with Continuous Emissions Monitoring System ('CEMS') and platform];*
- *Ancillary coolers;*
- *Fuel gas performance heating room*
- *Generator transformer and unit auxiliary transformer;*
- *OCGT power plant (140MW) [Including turbine enclosures, air intakes, fin fan coolers, emissions stack (45m high), electrical rooms, main transformer];*
- *Secondary fuel storage tanks and unloading area [Including unloading layby, 2 no. fuel storage tanks, fuel pumping and cleaning plant, fuel forwarding building];*
- *2 no. water abstraction boreholes;*
- *Raw water storage tank;*
- *2 no. demineralised water storage tanks;*
- *Water treatment plant;*
- *Administration building and staff car park;*
- *Wastewater treatment plant;*
- *Workshop and stores building;*
- *Process water treatment plant;*
- *Gas Above Ground Installation ('AGI') compound [Including regulator building, instrumentation kiosks, palisade fencing];*
- *Gas receiving facility [Including gas compressor building, fin fan coolers, pressure reducing station];*
- *Drainage infrastructure [Including surface water attenuation tank, surface water discharge pipeline (Discharging to the Mongagh River), treated process and wastewater discharge pipeline (Discharging to the Yellow River)];*
- *A new site access from the R400 road;*
- *All internal access roads;*
- *Security fencing and gates;*
- *Landscaping*
- *Site works and services*
- *All ancillary infrastructure and plant [Including firefighting systems, fire water pumphouse, raw water pumphouse, emergency diesel generator, propane stores, chemical storage tanks and pumphouse, lube oil storage building, silencers, vents, drains, safety valves, lighting, and pipe gantries];*
- *A permanent Peat and Spoil Deposition Area ('PDA') of approx. 225,000 sq. m. will be located to the south-east of the Power Plant Area.*

The development of the Electricity Grid Connection will include the following:

- *A 220kV substation located to the west of the Power Plant Area and R400 road [Hybrid gas insulated switchgear ('GIS')/air insulated switchgear ('AIS') substation design including switchgear building; control room building; transformer bays; 2. no. lattice gantries (c. 20m*

high) to support overhead line connection; telecommunications mast (c. 36m high); security fencing; landscaping, new access on to R400 road];

- *220kV overhead line running for c. 5km to the south of the 220kV substation, facilitated by double circuit suspension pylon towers (13 no.; c. 44m high) and strain pylon towers (6 no.; c. 38m high);*
- *220kV line-cable interface compound [Including interface tower gantry (c. 20m high); cable sealing ends; security fencing];*
- *220kV underground cable connection running for c. 3.4km to the south [With paved and gated service road and 12 no. joint bays to facilitate construction and servicing];*
- *A 400kV GIS substation located adjacent to the existing Oldstreet-Woodland 400kV overhead line [Including a 400kV GIS building; 220kV GIS building; transformer compound; 2 no. lattice gantries (c. 28m high) to support overhead line connection to 2 no. new loop-in strain towers (c. 32.5m high) on the Oldstreet-Woodland 400kV line; telecommunications mast (c. 36m high); security fencing; landscaping, access off L1010 road];*
- *2 no. permanent Peat Deposition Areas will be provided as part of the Electricity Grid Connection – one to the north of the 400kV substation (c. 75,300 sq. m) and one to the south-west of the 220kV substation (c. 50,200 sq. m.);*
- *Tree Replanting Areas (c. 17.5 ha.) are proposed within the planning boundary to compensate for all tree felling requirements associated with the Proposed Development.*

The application relates to development for the purposes of an activity requiring a license from the Environmental Protection Agency under the Industrial Emissions Directive. It also relates to a Lower Tier COMAH establishment and therefore falls under the requirements of the Control of Major Accident Hazard (COMAH) Regulations, 2015.

An Environmental Impact Assessment Report ('EIAR') and Natura Impact Statement ('NIS') will be submitted with the application.

The Proposed Development provides flexible, dispatchable electricity generation capacity which will help to maintain security of electricity supply into the future, while supporting Ireland in its transition to a low carbon economy in line with National Development Plan and Climate Action Plan objectives. It will help to replace generation capacity that will be lost through the planned retirement of older, more carbon-intensive power stations in the coming years and will facilitate a sustainable transition to renewable fuels such as hydrogen, in line with national commitments for blending renewable fuels into the gas network.

The application is being made directly to An Bord Pleanála² as 'Strategic Infrastructure Development'(SID) under the provisions of Section 37E the Planning and Development Act 2000 (as amended). An Bord Pleanála has required that we notify Offaly County Council of the submission of the application.

All documentation for this planning application can be found at www.derrygreenaghpowerplanning.ie , including:

- ABP SID Planning Application Form and Appendices

² An Bord Pleanála, 64 Marlborough Street, Dublin 1

- Cover Letter and Appendices
- Planning Statement
- Drainage Engineering Assessment Report
- Environmental Impact Assessment Report (EIAR)³
- Application Drawings

You are advised that the Board may, in respect of an application for permission, decide to:

- (a) (i) grant the permission/approval,
or
- (ii) make such modifications to the proposed development as it specifies in its decision and grant permission/approval in respect of the proposed development as so modified,
or
- (iii) grant permission/approval in respect of part of the proposed development (with or without specified modifications of the foregoing kind), and any of the above decisions may be subject to or without conditions,
or
- (b) Refuse to grant the permission/approval.

Submissions or Observations may be made only to An Bord Pleanála, 64 Marlborough Street, Dublin 1 relating to:

- i. The implications of the proposed development for proper planning and sustainable development, and
- ii. The likely effects on the environment of the proposed development, and
- iii. The likely significant effects of the proposed development on a European site, if carried out.

Any submissions/observations must be received by the Board no later than 5.30 p.m. on 5th April 2024.

Yours sincerely,



Sean Breslin

Senior Consultant, Planning

³ Includes Natura Impact Statement and COMAH Land Use Planning Risk Assessment

07 February 2024

Eastern and Midland Regional Assembly,
3rd Floor North Ballymun Civic Centre,
Main Street,
Ballymun,
Dublin 9,
Ireland,
D09 C8P5

Dear Sir/Madam,

Proposal: Strategic Infrastructure Development - Proposed Combined Cycle Gas Turbine (570MW) and an Open Cycle Gas Turbine (140MW) Thermal Power Plant and electricity grid connection including 2 no substations and associated buildings, plant, site works services and ancillary development on land within the townlands of Knockdrin, Derrygreenagh, Derryarkin, Derryiron, Ballybeg, Coolcor, Barrysbrook, Clonin, Togher and Coole, Co. Offaly.

On behalf of the applicant, Bord na Móna Powergen Limited¹, we hereby submit a planning application for Strategic Infrastructure Development ('SID') for a Combined Cycle Gas Turbine ('CCGT') and Open Cycle Gas Turbine ('OCGT') Thermal Power Plant, Electricity Grid Connection including 2 no. substations, and associated buildings, plant, site works, services and ancillary development on land within the townlands of Knockdrin, Derrygreenagh, Derryarkin, Derryiron, Ballybeg, Coolcor, Barrysbrook, Clonin, Togher and Coole, Co. Offaly.

The development description reads as follows:

10-year planning permission to develop a Combined Cycle Gas Turbine ('CCGT') and Open Cycle Gas Turbine ('OCGT') Thermal Power Plant, Electricity Grid Connection including 2 no. substations, and associated buildings, plant, site works, services and ancillary development on land within the townlands of Knockdrin, Derrygreenagh, Derryarkin, Derryiron, Ballybeg, Coolcor, Barrysbrook, Clonin, Togher and Coole, Co. Offaly.

The Proposed Development will encompass a Power Plant Area and an Electricity Grid Connection.

¹ c/o Bord na Mona, Main Street, Newbridge, Co Kildare

The development of the Power Plant Area will include the following:

- *Demolition of existing buildings at the Derrygreenagh Works site (Including office building, boiler house, workshops, water tank and storage unit);*
- *Construction of CCGT power plant (570MW) [Including turbine hall and associated buildings, air cooled condensers ('ACC'), Heat Recovery Steam Generator ('HRSG'), air intake, emissions stack (60m high) with Continuous Emissions Monitoring System ('CEMS') and platform];*
- *Ancillary coolers;*
- *Fuel gas performance heating room*
- *Generator transformer and unit auxiliary transformer;*
- *OCGT power plant (140MW) [Including turbine enclosures, air intakes, fin fan coolers, emissions stack (45m high), electrical rooms, main transformer];*
- *Secondary fuel storage tanks and unloading area [Including unloading layby, 2 no. fuel storage tanks, fuel pumping and cleaning plant, fuel forwarding building];*
- *2 no. water abstraction boreholes;*
- *Raw water storage tank;*
- *2 no. demineralised water storage tanks;*
- *Water treatment plant;*
- *Administration building and staff car park;*
- *Wastewater treatment plant;*
- *Workshop and stores building;*
- *Process water treatment plant;*
- *Gas Above Ground Installation ('AGI') compound [Including regulator building, instrumentation kiosks, palisade fencing];*
- *Gas receiving facility [Including gas compressor building, fin fan coolers, pressure reducing station];*
- *Drainage infrastructure [Including surface water attenuation tank, surface water discharge pipeline (Discharging to the Mongagh River), treated process and wastewater discharge pipeline (Discharging to the Yellow River)];*
- *A new site access from the R400 road;*
- *All internal access roads;*
- *Security fencing and gates;*
- *Landscaping*
- *Site works and services*
- *All ancillary infrastructure and plant [Including firefighting systems, fire water pumphouse, raw water pumphouse, emergency diesel generator, propane stores, chemical storage tanks and pumphouse, lube oil storage building, silencers, vents, drains, safety valves, lighting, and pipe gantries];*
- *A permanent Peat and Spoil Deposition Area ('PDA') of approx. 225,000 sq. m. will be located to the south-east of the Power Plant Area.*

The development of the Electricity Grid Connection will include the following:

- *A 220kV substation located to the west of the Power Plant Area and R400 road [Hybrid gas insulated switchgear ('GIS')/air insulated switchgear ('AIS') substation design including switchgear building; control room building; transformer bays; 2. no. lattice gantries (c. 20m*

high) to support overhead line connection; telecommunications mast (c. 36m high); security fencing; landscaping, new access on to R400 road];

- *220kV overhead line running for c. 5km to the south of the 220kV substation, facilitated by double circuit suspension pylon towers (13 no.; c. 44m high) and strain pylon towers (6 no.; c. 38m high);*
- *220kV line-cable interface compound [Including interface tower gantry (c. 20m high); cable sealing ends; security fencing];*
- *220kV underground cable connection running for c. 3.4km to the south [With paved and gated service road and 12 no. joint bays to facilitate construction and servicing];*
- *A 400kV GIS substation located adjacent to the existing Oldstreet-Woodland 400kV overhead line [Including a 400kV GIS building; 220kV GIS building; transformer compound; 2 no. lattice gantries (c. 28m high) to support overhead line connection to 2 no. new loop-in strain towers (c. 32.5m high) on the Oldstreet-Woodland 400kV line; telecommunications mast (c. 36m high); security fencing; landscaping, access off L1010 road];*
- *2 no. permanent Peat Deposition Areas will be provided as part of the Electricity Grid Connection – one to the north of the 400kV substation (c. 75,300 sq. m) and one to the south-west of the 220kV substation (c. 50,200 sq. m.);*
- *Tree Replanting Areas (c. 17.5 ha.) are proposed within the planning boundary to compensate for all tree felling requirements associated with the Proposed Development.*

The application relates to development for the purposes of an activity requiring a license from the Environmental Protection Agency under the Industrial Emissions Directive. It also relates to a Lower Tier COMAH establishment and therefore falls under the requirements of the Control of Major Accident Hazard (COMAH) Regulations, 2015.

An Environmental Impact Assessment Report ('EIAR') and Natura Impact Statement ('NIS') will be submitted with the application.

The Proposed Development provides flexible, dispatchable electricity generation capacity which will help to maintain security of electricity supply into the future, while supporting Ireland in its transition to a low carbon economy in line with National Development Plan and Climate Action Plan objectives. It will help to replace generation capacity that will be lost through the planned retirement of older, more carbon-intensive power stations in the coming years and will facilitate a sustainable transition to renewable fuels such as hydrogen, in line with national commitments for blending renewable fuels into the gas network.

The application is being made directly to An Bord Pleanála² as 'Strategic Infrastructure Development'(SID) under the provisions of Section 37E the Planning and Development Act 2000 (as amended). An Bord Pleanála has required that we notify the Eastern and Midland Regional Assembly of the submission of the application.

All documentation for this planning application can be found at www.derrygreenaghpowerplanning.ie, including:

- ABP SID Planning Application Form and Appendices

² An Bord Pleanála, 64 Marlborough Street, Dublin 1

- Cover Letter and Appendices
- Planning Statement
- Drainage Engineering Assessment Report
- Environmental Impact Assessment Report (EIAR)³
- Application Drawings

You are advised that the Board may, in respect of an application for permission, decide to:

- (a) (i) grant the permission/approval,
or
(ii) make such modifications to the proposed development as it specifies in its decision and grant permission/approval in respect of the proposed development as so modified,
or
(iii) grant permission/approval in respect of part of the proposed development (with or without specified modifications of the foregoing kind), and any of the above decisions may be subject to or without conditions,
or
- (b) Refuse to grant the permission/approval.

Submissions or Observations may be made only to An Bord Pleanála, 64 Marlborough Street, Dublin 1 relating to:

- i. The implications of the proposed development for proper planning and sustainable development, and
- ii. The likely effects on the environment of the proposed development, and
- iii. The likely significant effects of the proposed development on a European site, if carried out.

Any submissions/observations must be received by the Board no later than 5.30 p.m. on 5th April 2024.

Yours sincerely,



Sean Breslin

Senior Consultant, Planning

³ Includes Natura Impact Statement and COMAH Land Use Planning Risk Assessment

07 February 2024

Transport Infrastructure Ireland,
Parkgate Business Centre,
Parkgate Street,
Dublin 8,
D08 DK10

Dear Sir/Madam,

Proposal: Strategic Infrastructure Development - Proposed Combined Cycle Gas Turbine (570MW) and an Open Cycle Gas Turbine (140MW) Thermal Power Plant and electricity grid connection including 2 no substations and associated buildings, plant, site works services and ancillary development on land within the townlands of Knockdrin, Derrygreenagh, Derryarkin, Derryiron, Ballybeg, Coolcor, Barrysbrook, Clonin, Togher and Coole, Co. Offaly.

On behalf of the applicant, Bord na Móna Powergen Limited¹, we hereby submit a planning application for Strategic Infrastructure Development ('SID') for a Combined Cycle Gas Turbine ('CCGT') and Open Cycle Gas Turbine ('OCGT') Thermal Power Plant, Electricity Grid Connection including 2 no. substations, and associated buildings, plant, site works, services and ancillary development on land within the townlands of Knockdrin, Derrygreenagh, Derryarkin, Derryiron, Ballybeg, Coolcor, Barrysbrook, Clonin, Togher and Coole, Co. Offaly.

The development description reads as follows:

10-year planning permission to develop a Combined Cycle Gas Turbine ('CCGT') and Open Cycle Gas Turbine ('OCGT') Thermal Power Plant, Electricity Grid Connection including 2 no. substations, and associated buildings, plant, site works, services and ancillary development on land within the townlands of Knockdrin, Derrygreenagh, Derryarkin, Derryiron, Ballybeg, Coolcor, Barrysbrook, Clonin, Togher and Coole, Co. Offaly.

The Proposed Development will encompass a Power Plant Area and an Electricity Grid Connection.

The development of the Power Plant Area will include the following:

¹ c/o Bord na Mona, Main Street, Newbridge, Co Kildare

- *Demolition of existing buildings at the Derrygreenagh Works site (Including office building, boiler house, workshops, water tank and storage unit);*
- *Construction of CCGT power plant (570MW) [Including turbine hall and associated buildings, air cooled condensers ('ACC'), Heat Recovery Steam Generator ('HRSG'), air intake, emissions stack (60m high) with Continuous Emissions Monitoring System ('CEMS') and platform];*
- *Ancillary coolers;*
- *Fuel gas performance heating room*
- *Generator transformer and unit auxiliary transformer;*
- *OCGT power plant (140MW) [Including turbine enclosures, air intakes, fin fan coolers, emissions stack (45m high), electrical rooms, main transformer];*
- *Secondary fuel storage tanks and unloading area [Including unloading layby, 2 no. fuel storage tanks, fuel pumping and cleaning plant, fuel forwarding building];*
- *2 no. water abstraction boreholes;*
- *Raw water storage tank;*
- *2 no. demineralised water storage tanks;*
- *Water treatment plant;*
- *Administration building and staff car park;*
- *Wastewater treatment plant;*
- *Workshop and stores building;*
- *Process water treatment plant;*
- *Gas Above Ground Installation ('AGI') compound [Including regulator building, instrumentation kiosks, palisade fencing];*
- *Gas receiving facility [Including gas compressor building, fin fan coolers, pressure reducing station];*
- *Drainage infrastructure [Including surface water attenuation tank, surface water discharge pipeline (Discharging to the Mongagh River), treated process and wastewater discharge pipeline (Discharging to the Yellow River)];*
- *A new site access from the R400 road;*
- *All internal access roads;*
- *Security fencing and gates;*
- *Landscaping*
- *Site works and services*
- *All ancillary infrastructure and plant [Including firefighting systems, fire water pumphouse, raw water pumphouse, emergency diesel generator, propane stores, chemical storage tanks and pumphouse, lube oil storage building, silencers, vents, drains, safety valves, lighting, and pipe gantries];*
- *A permanent Peat and Spoil Deposition Area ('PDA') of approx. 225,000 sq. m. will be located to the south-east of the Power Plant Area.*

The development of the Electricity Grid Connection will include the following:

- *A 220kV substation located to the west of the Power Plant Area and R400 road [Hybrid gas insulated switchgear ('GIS')/air insulated switchgear ('AIS') substation design including switchgear building; control room building; transformer bays; 2. no. lattice gantries (c. 20m high) to support overhead line connection; telecommunications mast (c. 36m high); security fencing; landscaping, new access on to R400 road];*

- 220kV overhead line running for c. 5km to the south of the 220kV substation, facilitated by double circuit suspension pylon towers (13 no.; c. 44m high) and strain pylon towers (6 no.; c. 38m high);
- 220kV line-cable interface compound [Including interface tower gantry (c. 20m high); cable sealing ends; security fencing];
- 220kV underground cable connection running for c. 3.4km to the south [With paved and gated service road and 12 no. joint bays to facilitate construction and servicing];
- A 400kV GIS substation located adjacent to the existing Oldstreet-Woodland 400kV overhead line [Including a 400kV GIS building; 220kV GIS building; transformer compound; 2 no. lattice gantries (c. 28m high) to support overhead line connection to 2 no. new loop-in strain towers (c. 32.5m high) on the Oldstreet-Woodland 400kV line; telecommunications mast (c. 36m high); security fencing; landscaping, access off L1010 road];
- 2 no. permanent Peat Deposition Areas will be provided as part of the Electricity Grid Connection – one to the north of the 400kV substation (c. 75,300 sq. m) and one to the south-west of the 220kV substation (c. 50,200 sq. m.);
- Tree Replanting Areas (c. 17.5 ha.) are proposed within the planning boundary to compensate for all tree felling requirements associated with the Proposed Development.

The application relates to development for the purposes of an activity requiring a license from the Environmental Protection Agency under the Industrial Emissions Directive. It also relates to a Lower Tier COMAH establishment and therefore falls under the requirements of the Control of Major Accident Hazard (COMAH) Regulations, 2015.

An Environmental Impact Assessment Report ('EIAR') and Natura Impact Statement ('NIS') will be submitted with the application.

The Proposed Development provides flexible, dispatchable electricity generation capacity which will help to maintain security of electricity supply into the future, while supporting Ireland in its transition to a low carbon economy in line with National Development Plan and Climate Action Plan objectives. It will help to replace generation capacity that will be lost through the planned retirement of older, more carbon-intensive power stations in the coming years and will facilitate a sustainable transition to renewable fuels such as hydrogen, in line with national commitments for blending renewable fuels into the gas network.

The application is being made directly to An Bord Pleanála² as 'Strategic Infrastructure Development' (SID) under the provisions of Section 37E the Planning and Development Act 2000 (as amended). An Bord Pleanála has required that we notify Transport Infrastructure Ireland of the submission of the application.

All documentation for this planning application can be found at www.derrygreenaghpowerplanning.ie, including:

- ABP SID Planning Application Form and Appendices
- Cover Letter and Appendices
- Planning Statement

² An Bord Pleanála, 64 Marlborough Street, Dublin 1

- Drainage Engineering Assessment Report
- Environmental Impact Assessment Report (EIAR)³
- Application Drawings

You are advised that the Board may, in respect of an application for permission, decide to:

- (a) (i) grant the permission/approval,
or
- (ii) make such modifications to the proposed development as it specifies in its decision and grant permission/approval in respect of the proposed development as so modified,
or
- (iii) grant permission/approval in respect of part of the proposed development (with or without specified modifications of the foregoing kind), and any of the above decisions may be subject to or without conditions,
or
- (b) Refuse to grant the permission/approval.

Submissions or Observations may be made only to An Bord Pleanála, 64 Marlborough Street, Dublin 1 relating to:

- i. The implications of the proposed development for proper planning and sustainable development, and
- ii. The likely effects on the environment of the proposed development, and
- iii. The likely significant effects of the proposed development on a European site, if carried out.

Any submissions/observations must be received by the Board no later than 5.30 p.m. on 5th April 2024.

Yours sincerely,



Sean Breslin

Senior Consultant, Planning

³ Includes Natura Impact Statement and COMAH Land Use Planning Risk Assessment

07 February 2024

Westmeath County Council,
Áras an Chontae,
Mount Street,
Mullingar
N91 FH4N

Dear Sir/Madam,

Proposal: Strategic Infrastructure Development - Proposed Combined Cycle Gas Turbine (570MW) and an Open Cycle Gas Turbine (140MW) Thermal Power Plant and electricity grid connection including 2 no substations and associated buildings, plant, site works services and ancillary development on land within the townlands of Knockdrin, Derrygreenagh, Derryarkin, Derryiron, Ballybeg, Coolcor, Barrysbrook, Clonin, Togher and Coole, Co. Offaly.

On behalf of the applicant, Bord na Móna Powergen Limited¹, we hereby submit a planning application for Strategic Infrastructure Development ('SID') for a Combined Cycle Gas Turbine ('CCGT') and Open Cycle Gas Turbine ('OCGT') Thermal Power Plant, Electricity Grid Connection including 2 no. substations, and associated buildings, plant, site works, services and ancillary development on land within the townlands of Knockdrin, Derrygreenagh, Derryarkin, Derryiron, Ballybeg, Coolcor, Barrysbrook, Clonin, Togher and Coole, Co. Offaly.

The development description reads as follows:

10-year planning permission to develop a Combined Cycle Gas Turbine ('CCGT') and Open Cycle Gas Turbine ('OCGT') Thermal Power Plant, Electricity Grid Connection including 2 no. substations, and associated buildings, plant, site works, services and ancillary development on land within the townlands of Knockdrin, Derrygreenagh, Derryarkin, Derryiron, Ballybeg, Coolcor, Barrysbrook, Clonin, Togher and Coole, Co. Offaly.

The Proposed Development will encompass a Power Plant Area and an Electricity Grid Connection.

The development of the Power Plant Area will include the following:

¹ c/o Bord na Mona, Main Street, Newbridge, Co Kildare

- *Demolition of existing buildings at the Derrygreenagh Works site (Including office building, boiler house, workshops, water tank and storage unit);*
- *Construction of CCGT power plant (570MW) [Including turbine hall and associated buildings, air cooled condensers ('ACC'), Heat Recovery Steam Generator ('HRSG'), air intake, emissions stack (60m high) with Continuous Emissions Monitoring System ('CEMS') and platform];*
- *Ancillary coolers;*
- *Fuel gas performance heating room*
- *Generator transformer and unit auxiliary transformer;*
- *OCGT power plant (140MW) [Including turbine enclosures, air intakes, fin fan coolers, emissions stack (45m high), electrical rooms, main transformer];*
- *Secondary fuel storage tanks and unloading area [Including unloading layby, 2 no. fuel storage tanks, fuel pumping and cleaning plant, fuel forwarding building];*
- *2 no. water abstraction boreholes;*
- *Raw water storage tank;*
- *2 no. demineralised water storage tanks;*
- *Water treatment plant;*
- *Administration building and staff car park;*
- *Wastewater treatment plant;*
- *Workshop and stores building;*
- *Process water treatment plant;*
- *Gas Above Ground Installation ('AGI') compound [Including regulator building, instrumentation kiosks, palisade fencing];*
- *Gas receiving facility [Including gas compressor building, fin fan coolers, pressure reducing station];*
- *Drainage infrastructure [Including surface water attenuation tank, surface water discharge pipeline (Discharging to the Mongagh River), treated process and wastewater discharge pipeline (Discharging to the Yellow River)];*
- *A new site access from the R400 road;*
- *All internal access roads;*
- *Security fencing and gates;*
- *Landscaping*
- *Site works and services*
- *All ancillary infrastructure and plant [Including firefighting systems, fire water pumphouse, raw water pumphouse, emergency diesel generator, propane stores, chemical storage tanks and pumphouse, lube oil storage building, silencers, vents, drains, safety valves, lighting, and pipe gantries];*
- *A permanent Peat and Spoil Deposition Area ('PDA') of approx. 225,000 sq. m. will be located to the south-east of the Power Plant Area.*

The development of the Electricity Grid Connection will include the following:

- *A 220kV substation located to the west of the Power Plant Area and R400 road [Hybrid gas insulated switchgear ('GIS')/air insulated switchgear ('AIS') substation design including switchgear building; control room building; transformer bays; 2. no. lattice gantries (c. 20m high) to support overhead line connection; telecommunications mast (c. 36m high); security fencing; landscaping, new access on to R400 road];*

- 220kV overhead line running for c. 5km to the south of the 220kV substation, facilitated by double circuit suspension pylon towers (13 no.; c. 44m high) and strain pylon towers (6 no.; c. 38m high);
- 220kV line-cable interface compound [Including interface tower gantry (c. 20m high); cable sealing ends; security fencing];
- 220kV underground cable connection running for c. 3.4km to the south [With paved and gated service road and 12 no. joint bays to facilitate construction and servicing];
- A 400kV GIS substation located adjacent to the existing Oldstreet-Woodland 400kV overhead line [Including a 400kV GIS building; 220kV GIS building; transformer compound; 2 no. lattice gantries (c. 28m high) to support overhead line connection to 2 no. new loop-in strain towers (c. 32.5m high) on the Oldstreet-Woodland 400kV line; telecommunications mast (c. 36m high); security fencing; landscaping, access off L1010 road];
- 2 no. permanent Peat Deposition Areas will be provided as part of the Electricity Grid Connection – one to the north of the 400kV substation (c. 75,300 sq. m) and one to the south-west of the 220kV substation (c. 50,200 sq. m.);
- Tree Replanting Areas (c. 17.5 ha.) are proposed within the planning boundary to compensate for all tree felling requirements associated with the Proposed Development.

The application relates to development for the purposes of an activity requiring a license from the Environmental Protection Agency under the Industrial Emissions Directive. It also relates to a Lower Tier COMAH establishment and therefore falls under the requirements of the Control of Major Accident Hazard (COMAH) Regulations, 2015.

An Environmental Impact Assessment Report ('EIAR') and Natura Impact Statement ('NIS') will be submitted with the application.

The Proposed Development provides flexible, dispatchable electricity generation capacity which will help to maintain security of electricity supply into the future, while supporting Ireland in its transition to a low carbon economy in line with National Development Plan and Climate Action Plan objectives. It will help to replace generation capacity that will be lost through the planned retirement of older, more carbon-intensive power stations in the coming years and will facilitate a sustainable transition to renewable fuels such as hydrogen, in line with national commitments for blending renewable fuels into the gas network.

The application is being made directly to An Bord Pleanála² as 'Strategic Infrastructure Development' (SID) under the provisions of Section 37E the Planning and Development Act 2000 (as amended). An Bord Pleanála has required that we notify Westmeath County Council of the submission of the application.

All documentation for this planning application can be found at www.derrygreenaghpowerplanning.ie, including:

- ABP SID Planning Application Form and Appendices
- Cover Letter and Appendices
- Planning Statement

² An Bord Pleanála, 64 Marlborough Street, Dublin 1

- Drainage Engineering Assessment Report
- Environmental Impact Assessment Report (EIAR)³
- Application Drawings

You are advised that the Board may, in respect of an application for permission, decide to:

- (a) (i) grant the permission/approval,
or
- (ii) make such modifications to the proposed development as it specifies in its decision and grant permission/approval in respect of the proposed development as so modified,
or
- (iii) grant permission/approval in respect of part of the proposed development (with or without specified modifications of the foregoing kind), and any of the above decisions may be subject to or without conditions,
or
- (b) Refuse to grant the permission/approval.

Submissions or Observations may be made only to An Bord Pleanála, 64 Marlborough Street, Dublin 1 relating to:

- i. The implications of the proposed development for proper planning and sustainable development, and
- ii. The likely effects on the environment of the proposed development, and
- iii. The likely significant effects of the proposed development on a European site, if carried out.

Any submissions/observations must be received by the Board no later than 5.30 p.m. on 5th April 2024.

Yours sincerely,



Sean Breslin

Senior Consultant, Planning

³ Includes Natura Impact Statement and COMAH Land Use Planning Risk Assessment

Appendix G – EIA Portal Confirmation

From: [Housing Eiaportal](#)
To: [Sean Breslin](#)
Subject: EIA Portal Confirmation Notice Portal ID 2024020
Date: 02 February 2024 16:57:25

Dear Sean,

An EIA Portal notification was received on 02/02/2024 in respect of this proposed application. The information provided has been uploaded to the EIA Portal on 02/02/2024 under EIA Portal ID number 2024020 and is available to view at <http://housinggovie.maps.arcgis.com/apps/webappviewer/index.html?id=d7d5a3d48f104ecbb206e7e5f84b71f1>.

Portal ID: 2024020

Competent Authority: An Bord Pleanála

Applicant Name: Bord na Móna Powergen Limited

Location: Land within the townlands of Knockdrin, Derrygreenagh, Derryarkin, Derryiron, Ballybeg, Coolcor, Barrysbrook, Clonin, Togher and Coole, Co. Offaly.

Description: Combined Cycle Gas Turbine ('CCGT') and Open Cycle Gas Turbine ('OCGT') Thermal Power Plant, Electricity Grid Connection including 2 no. substations, and associated buildings, plant, site works, services and ancillary development.

Linear Development: Yes

Date Uploaded to Portal: 02/02/2024

Kindest Regards,

Hugh Wogan,

EIA Portal team

—

An Roinn Tithíochta, Rialtais Áitiúil agus Oidhreachta
Department of Housing, Local Government and Heritage

Teach an Chustaim, Baile Átha Cliath 1, D01 W6X0
Custom House, Dublin 1, D01 W6X0

—

T +353 (0) 1 888 2142

www.gov.ie/housing